



KENT VALVE
CRITICAL PRESSURE & FLOW CONTROL

GATE, GLOBE & CHECK VALVES- BOLTED BONNET

**NPS 1" - 72" (DN50 - DN1800), ASME Class 150# - 2500#
API 600 / ASME B16.34**



AN ISO 9001:2015, ISO 14001:2015, ISO 45001:2018 CERTIFIED COMPANY

www.kentvalve.com



KENT VALVE PROFILE

KENT VALVE is a fast growing valve manufacturing Company. Our wide range of superior quality valves especially designed to control water flow, gas, steam, air, and oil. The perfect blend of deep domain knowledge, technology experience and quality valves have enabled us to become leaders in the valve industry. Our quality team and proficient engineers make sure that we are delivering quality products in market. Our skilled professionals and technology competency, coupled with a reliable manufacturing process allows us to deliver end-to-end flow solutions especially catered to the user's needs and requirements.

KENT VALVE is a professional engineering firm, offering a broad spectrum of technical products and solutions, especially Valves, Instruments, Analyzers and spares to the Oil and Gas, Power Plants, Refineries, Petrochemical, Marine, Pulp & Paper, Water Treatment, District cooling, Solar Power, Irrigation and General Industry sectors, We have a proven track record and a reputation for quality and reliability in the selection of Valves, Instruments and Analyzers. We do Service support and On- time delivery of the world's leading Brand names in Valves, Analyzers and Process Instruments, KENT VALVE holds stock of comprehensive range of world leading brands of Gate, Globe, Check, DBB valves and Ball valves, Control globe valves, Safety Relief Valves, Electric and Pneumatic Actuators, etc.

KENT VALVE is a multinational company with group manufacturing plants at India, The United Kingdom and Italy. Kent has it's headquarter in Millano, Italy. It has sales office in Mumbai, Dubai, Sharjah, Kuwait, Oman, Italy and UK Etc. For meeting the requirements of its customers globally. The plant infrastructure comprises of highly efficient machine shop with a high level of quality aspects. It covers all the business processes like Sales, Design & Development, Procurement, Planning, Manufacturing, Quality, Store, Dispatch, HR and Finance.

PRODUCT RANGE

- Gate, Globe & Check Valves – Bolted Bonnet
- Gate, Globe & Check Valves – Pressure Seal
- Gate, Globe & Check Valves – Forged
- Ball Valves – Floating Top Entry, Trunnion Mounted, Double Block & Bleed
- Butterfly Valves – Concentric, Offset, Double Offset and Triple Offset
- Dual Plate Check Valves
- Single Plate Check Valves
- Control Valves
- Pressure Safety Valves
- Instrumentation Valves – Ball, Needle, Plug, Gate, Globe and Check
- Quick Exhaust & Flow Control Valves
- Knife Edge Gate Valve
- Valve, Actuator & Automation system

MANUFACTURING FACILITIES





CERTIFICATIONS



INTEGRATED MANAGEMENT SYSTEM POLICY
(Integration of ISO 9001:2015, ISO 14001:2015, ISO 45001:2018)

Kent valve Pvt. Ltd. is committed to the Integrated Management System that complies with ISO 9001:2015, ISO 14001:2015 & ISO 45001:2018 standards. We shall uphold the principles of this policy and promote a positive culture to create safe, healthy and environment-friendly workplace. We shall ensure that people at workplace take responsibility for aspects of Quality, Environment, Occupational Health & Safety over which we have control. We acknowledge the global concern on climate change and hence recognize energy as one of the most important resources used.

We shall continually improve our Integrated Management System to enhance its performance by:

- Enhancing customer satisfaction through manufacturing and delivery of environment friendly, safe & energy efficient products and services of right quality and on right time;
- Selecting and building partnership with external providers of processes, products and services to create the co-ownership of goals and exhibiting high level of ethical values;
- Involving employees at all levels and enhancing their competence through training, awareness and skill enhancement to fulfil stakeholders expectations;
- Fulfilling and satisfying the applicable Statutory, Regulatory, Legal requirements and other requirements related to environment, occupational health and safety, energy efficiency, use and consumption;
- Setting Integrated Management System objectives and reviewing them periodically against the target to ensure their achievement by availability of information and necessary resources;
- Protecting environment by prevention of pollution and 'reduction-reuse-recycling' of wastes and ensuring its environment-friendly disposal;
- Identifying, eliminating, isolating and controlling hazards and risks to avoid incidents/ accidents and ill health;
- Encouraging and promoting consultation and participation of those working under the control of organization in all occupational health & safety related activities.

This policy shall be communicated to all employees and made available to interested parties.

Issue no. 02
Issue date: 17 May 2022



(Neyaz Khan)
Director



CERTIFICATE

Management system as per
ISO 9001 : 2015

The Certification Body TÜV NORD CERT GmbH hereby confirms as a result of the audit, assessment and certification decision according to ISO/IEC 17021-1:2015, that the organization

KENT VALVE PRIVATE LIMITED
Plot No-B-85/4, Ambernath Additional MIDC,
Anand Nagar, Nr. ASB Company,
Ambernath, Thane - 421 506,
Maharashtra,
India



operates a management system in accordance with the requirements of ISO 9001 : 2015 and will be assessed for conformity within the 3 year term of validity of the certificate.

Scope -
Design and Manufacture of Industrial Valves, Actuators and Valve Automation Systems.

Certificate Registration No. 44 100 22393731
Audit Report No. 2.5-10841/2022

Valid from 25.08.2022
Valid until 24.08.2025
Initial certification 25.08.2022



Certification Body
at TÜV NORD CERT GmbH

Mumbai, 28.11.2023

TÜV NORD CERT GmbH Am TÜV 1 45307 Essen www.tuev-nord-cert.com
TUV India Pvt. Ltd., 801, Raheja Plaza – 1, L.B.S. Marg, Ghatkopar (W), Mumbai - 400 086, India www.tuv-nord.com/in





CERTIFICATE

Management system as per
ISO 14001 : 2015

The Certification Body TÜV NORD CERT GmbH hereby confirms as a result of the audit, assessment and certification decision according to ISO/IEC 17021-1:2015, that the organization

KENT VALVE PRIVATE LIMITED
Plot No-B-85/4, Ambernath Additional MIDC,
Anand Nagar, Nr. ASB Company,
Ambernath, Thane - 421 506,
Maharashtra,
India



operates a management system in accordance with the requirements of ISO 14001 : 2015 and will be assessed for conformity within the 3 year term of validity of the certificate.

Scope -
Design and Manufacture of Industrial Valves, Actuators and Valve Automation Systems.

Certificate Registration No. 44 104 22393731
Audit Report No. 2.5-10841/2022

Valid from 25.08.2022
Valid until 24.08.2025
Initial certification 25.08.2022



Certification Body
at TÜV NORD CERT GmbH

Mumbai, 28.11.2023

TÜV NORD CERT GmbH Am TÜV 1 45307 Essen www.tuev-nord-cert.com
TUV India Pvt. Ltd., 801, Raheja Plaza – 1, L.B.S. Marg, Ghatkopar (W), Mumbai - 400 086, India www.tuv-nord.com/in





CERTIFICATE

Management system as per
ISO 45001 : 2018

The Certification Body TÜV NORD CERT GmbH hereby confirms as a result of the audit, assessment and certification decision according to ISO/IEC 17021-1:2015, that the organization

KENT VALVE PRIVATE LIMITED
Plot No-B-85/4, Ambernath Additional MIDC,
Anand Nagar, Nr. ASB Company,
Ambernath, Thane - 421 506,
Maharashtra,
India



operates a management system in accordance with the requirements of ISO 45001 : 2018 and will be assessed for conformity within the 3 year term of validity of the certificate.

Scope -
Design and Manufacture of Industrial Valves, Actuators and Valve Automation Systems.

Certificate Registration No. 44 126 22393731
Audit Report No. 2.5-10841/2022

Valid from 25.08.2022
Valid until 24.08.2025
Initial certification 25.08.2022



Certification Body
at TÜV NORD CERT GmbH

Mumbai, 28.11.2023

TÜV NORD CERT GmbH Am TÜV 1 45307 Essen www.tuev-nord-cert.com
TUV India Pvt. Ltd., 801, Raheja Plaza – 1, L.B.S. Marg, Ghatkopar (W), Mumbai - 400 086, India www.tuv-nord.com/in



GATE, GLOBE & CHECK VALVE – BOLTED BONNET

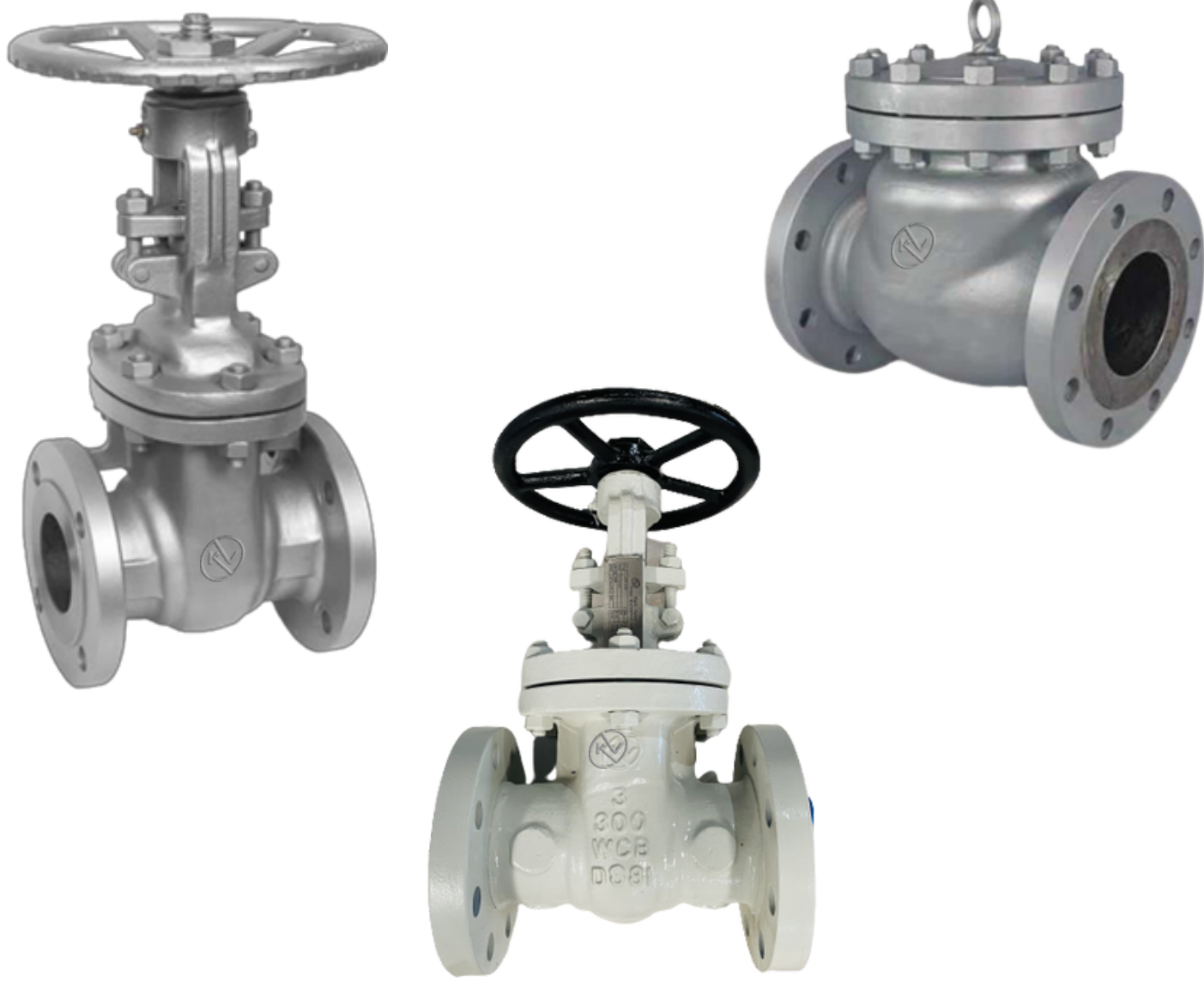

Kent Cast Steel Valves are designed and manufactured to conform to API, ASTM, ANSI and other applicable international standards. They are used in petroleum production sites, petrochemical plants, power stations, fertilizer plants, and other industrial applications.

PRODUCT RANGE

Valve Type	End Conn.	ASME Class	SIZE (NPS / DN)																							
			2	2-½	3	4	6	8	10	12	14	16	18	20	24	26	28	30	32	34	36	38	40	42		
			50	65	80	100	150	200	250	300	350	400	450	500	600	650	700	750	800	850	900	950	1000	1050		
Gate Valve	Flanged & Butt weld Ends	150	✓	✓	✓	✓	✓	✓	✓	✓	✓	✓	✓	✓	✓	✓	✓	✓	✓	✓	✓	✓	✓	✓		
		300	✓	✓	✓	✓	✓	✓	✓	✓	✓	✓	✓	✓	✓	✓	✓	✓	✓	✓	✓	✓	✓	✓	✓	
		600	✓	✓	✓	✓	✓	✓	✓	✓	✓	✓	✓	✓	✓	✓										
		900	✓	✓	✓	✓	✓	✓	✓	✓																
		1500	✓	✓	✓	✓	✓	✓	✓	✓																
		2500	✓	✓	✓	✓	✓																			
Globe Valve	Flanged & Butt weld Ends	150	✓	✓	✓	✓	✓	✓	✓	✓	✓	✓	✓	✓												
		300	✓	✓	✓	✓	✓	✓	✓	✓	✓	✓	✓	✓												
		600	✓	✓	✓	✓	✓	✓	✓	✓	✓	✓	✓	✓												
		900	✓	✓	✓	✓	✓	✓	✓	✓																
		1500	✓	✓	✓	✓	✓	✓	✓	✓																
		2500	✓	✓	✓	✓																				
Check Valve	Flanged & Butt weld Ends	150	✓	✓	✓	✓	✓	✓	✓	✓	✓	✓	✓	✓	✓	✓										
		300	✓	✓	✓	✓	✓	✓	✓	✓	✓	✓	✓	✓	✓	✓	✓									
		600	✓	✓	✓	✓	✓	✓	✓	✓	✓	✓	✓	✓	✓	✓	✓									
		900	✓	✓	✓	✓	✓	✓	✓	✓	✓															
		1500	✓	✓	✓	✓	✓	✓	✓	✓	✓															
		2500	✓	✓	✓	✓																				

*We also offer intermediate size and class as per client requirements.



DESIGN SPECIFICATION

Parameter		Compliance
Design	Gate Valve Globe Valve Check Valve	API 600, BS1414 / API 603, BS 1873* / API 623, BS 1868*
Face to Face		ASME B 16.10
Pressure – Temperature Rating		ASME B 16.34
End Flange Details		ASME B 16.5 / ASME B 16.47**
Butt – Weld End Details		ASME B 16.25
Inspection and Testing		API 598 / BS EN 12266-1

The valves also comply with applicable BS specifications :

* Shell wall thickness as per API 600.

** For valves larger than 24" (600), the flange drill shall be as per ASME B16.47.

RTJ flanges are also offered as optional for Class 600 & above.

We also provide valve ends (flange, butt-weld, socket weld, threaded end) as per client requirements.

Kent Valves has the distinction of having obtained a number of national and international approvals. Notable among these are:

- ISO 9001:2015, ISO 14001:2015 & ISO 45001:2018 certified.
- Specific company approvals from national and international oil majors and EPC contractors.
- Indian Boiler Regulation (IBR) certification for boiler application can be provided.



Standard Test Pressures

Every individual valves manufactured is inspected and pressure-tested to API 598 / BS EN 12266-1 as required for which test certificates are provided. The test pressure is selected as per material requirement specified in ASME B16.34

ASME Class	Hydrostatic Test Pressure ASME Class in kg/cm ² (psig)		Pneumatic low pressure closure test pressure in kg/cm ² (psig)
	Shell	Seat	
150	30 (428)	22 (314)	7 (100)
300	79 (1125)	58 (814)	7 (100)
600	157 (2225)	115(1628)	7 (100)
900	235 (3350)	172(2442)	7 (100)
1500	391 (5575)	287(4076)	7 (100)
2500	651 (9275)	478(6800)	7 (100)

Low Pressure Test for Swing Check Valves

In addition to the high pressure closure test, Swing Check Valves are subjected to low pressure hydrostatic closure test at a pressure of 25% of the high pressure closure test. The duration of the test is the same as per API 6D / API 598 / BS EN 12266-1.

KENT DESIGN SPECIFICATION

Kent Valves API 600/BS 1873 / API 623 /BS1868 family of Gate, Globe and Swing Check Valves is exceptionally sturdy, rugged and durable with a reputation for quality, integrity and long service. They are designed for tight sealing and ease of operation. The valve are available with flanged and butt-weld ends in pressure rating from ASME class 150 to class 2500, and in a variety of materials of construction such as carbon steel, alloy steel, stainless steel, inconel, monel, hastelloy and duplex.



GATE VALVE

Gate Valves are of flexible wedge, solid wedge, outside screw & yoke and bolted bonnet construction. The valves also conform to API 600 / B16.34 design.

Body and Bonnet

The body and bonnet are cast with uniform section and unique radius fillets to prevent stress concentration. The casting are precision machined for high performance.

The gate valve body has a straight through port without recesses except at the seat area. This ensures minimum turbulence, erosion and resistance to flow, long integral guide ribs in the body match with guide slots in the wedge for accurate alignment and guidance. Bonnet castings are of one piece design, where yoke is integral with the bonnet for gate valve of size up to 10" (250mm). This ensures accurate alignment of stem and a smooth operation.

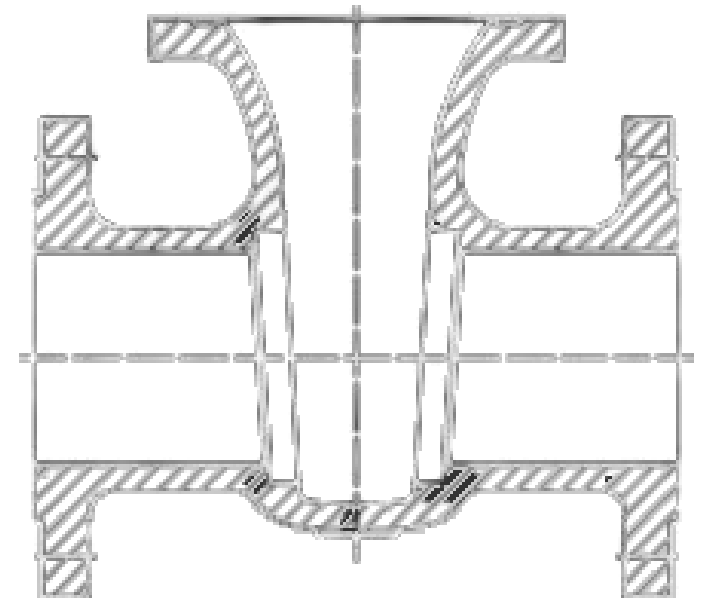

Gate Valve - Body

Body and Bonnet Joint

The body-bonnet joint for class 150 gate valves is oval in shape, while for class 300 and above, joint is circular in shape and upto 2" (50mm) valves, the body-bonnet joint has a square configuration.

Gate valves of class 150 rating have a flat-face joint with a graphite gasket having metallic inserts. Class 300 rating have male-female type joint with spiral-wound gasket. Gate valves of class 900 and above have a Ring Type Joint (RTJ) or as per client requirements.



Circular Joint

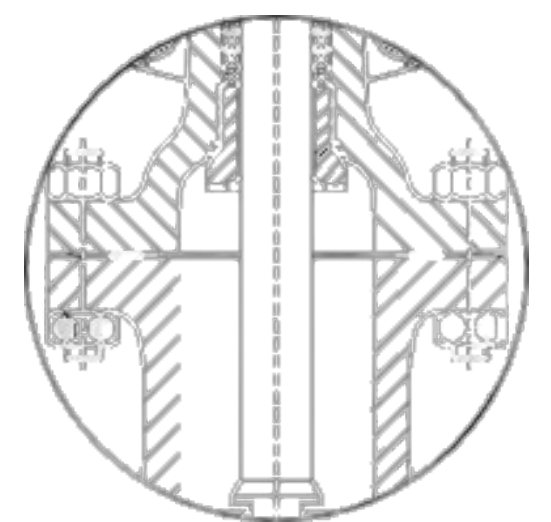

Square Joint

Seat Ring

Upto 50mm gate valves, the seat ring is flared into the body, while seal welding is optional.

Flexible Wedge versus Solid Wedge

Flexible Wedge

- Universal use for temperatures as per specific material requirements.
- Flexibility compensates for seat face distortion.
- Compensates for deformation of the body due to pipe stress.
- Long cycle life.
- Ideal for processes with large temperature fluctuations.
- Assures valve tightness on both seats over wide range of pressures.
- Stem-to-Wedge connection is inside the seating faces supporting the wedge ears during opening. More robust with less mass.

Solid Wedge

- Wedge may cause severe jamming at temperatures over 93° C (200°F).
- Suitable for small valves DN15-50 (NPS ½ - 2).
- Wedge will stick when valve is closed hot and allowed to cool.
- No compensation for deformation of the body due to pressure-temperature or pipe stresses.
- It needs skill to make valve tight on both side seats due to seat face distortion.
- Kent Valves has developed unique wedge design to minimize above problems.

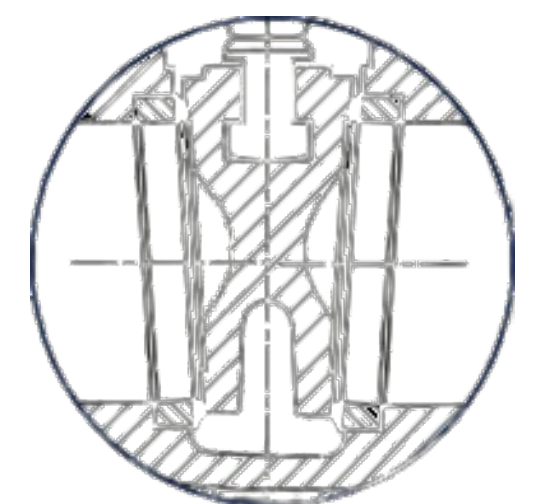

Flexible Wedge

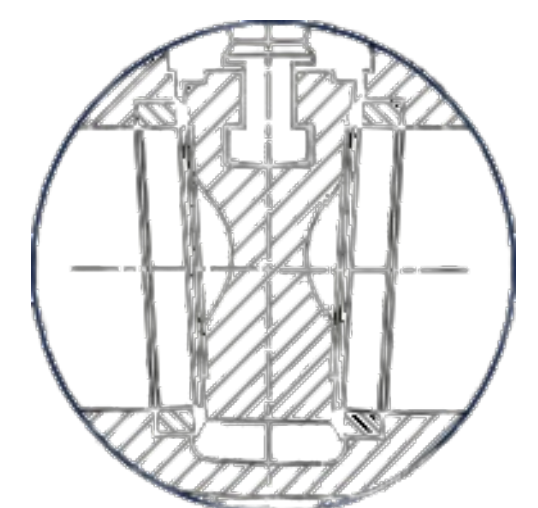

Solid Wedge



GLOBE VALVE

Globe Valves features unique design, outside screw & yoke, Y-type and bolted-bonnet construction. They are confirm to BS 1873 and also meet the general requirements of API 600 / ASME B16.34 / API 623 including shell wall thickness and stuffing box dimensions as per API 600. We provide API 623 Globe valves as per request.

Body and Bonnet

Globe valves of larger sizes and for higher pressure classes of ASME Class 900 and above, the internal part of the body and bonnet is machined to provide continuous guiding of the plug from the open to the closed position. This provides better stability for seat and back seat alignment & also leakage prevention.

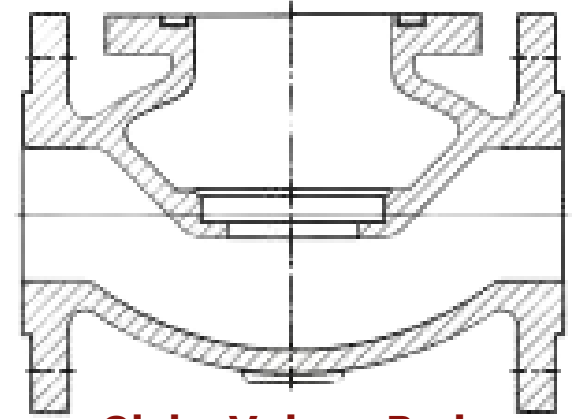

Globe Valve - Body

Ball-Type Plug

Kent Globe Valves feature a ball-type plug that provides a fine grain surface on the taper seat. For severe services that demand hard-faced seats, a ball-type plug is provided.

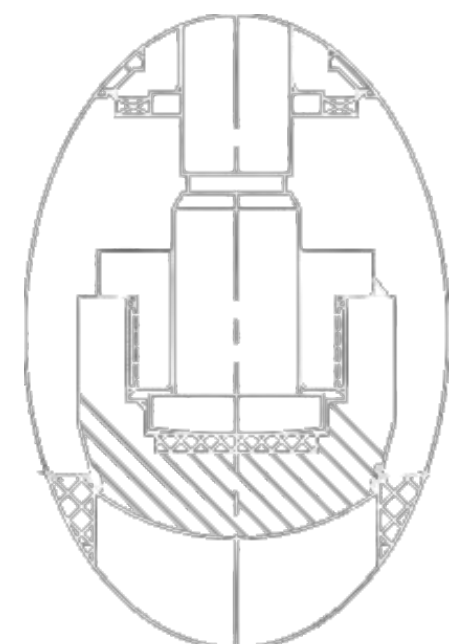

Ball Type Plug

SWING CHECK VALVE

Check Valves are of swing-type and bolted-cover construction. They confirm to BS 1868 and also meet the general requirements of API 600 including shell wall thickness.

Body and Cover

The check valves body provides a full port without pockets from inlet to outlet. On the downstream side, the body has generous proportions to facilitate full swing of the disc to reduce disc erosion and flow resistance.

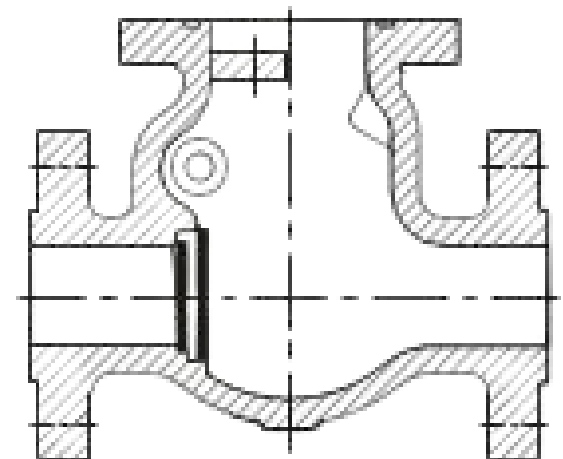

Check Valve - Body

Swing-Type Disc Arrangement

The one-piece construction is securely fastened to the hinge by means of a lock nut and pin. The disc is free to rotate to avoid localized wear. The hinge pin offers excellent wear resistance properties.

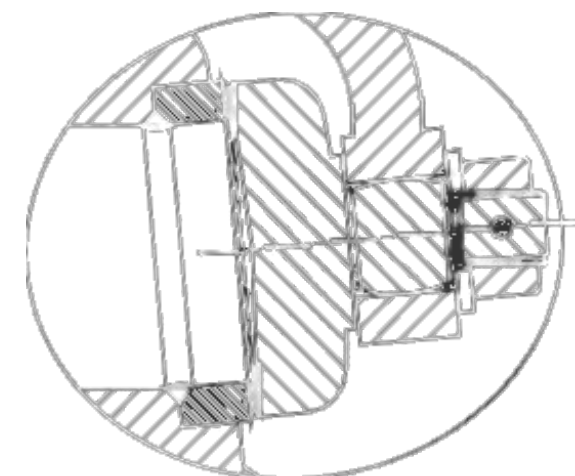

Swing - type Disc Arrangement

Seat Ring

Kent Check valve features a seal welded seat ring that offers a leakproof design, as it eliminates the leakage path between the seat ring and the body. This design is superior to threaded seat design which can loosen upon temperature fluctuations, corrosion or vibrations and result in leakage.

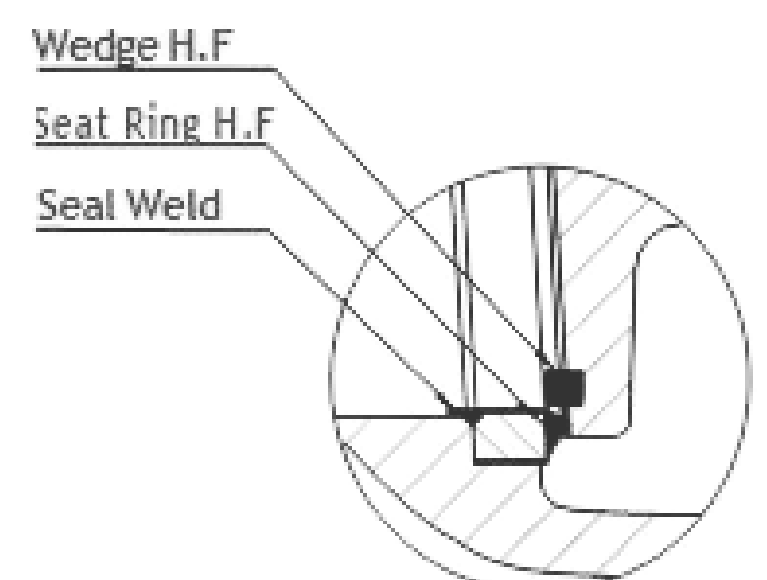



STANDARD MATERIAL OF CONSTRUCTION FOR GATE VALVE

Sl. No.	Description	Carbon Steel				Alloy Steel			SS
		WCB	WCC	LCB	LCC	C5	WC6	WC9	CF8
1	Body	A 216 Gr. WCB	A 216 Gr. WCC	A 352 Gr. LCB	A 352 Gr. LCC	A 217 Gr. C5	A 217 Gr. WC6	A 217 Gr. WC9	A 351 Gr. CF8
2	Bonnet	A 216 Gr. WCB	A 216 Gr. WCC	A 352 Gr. LCB	A 352 Gr. LCC	A 217 Gr. C5	A 217 Gr. WC6	A 217 Gr. WC9	A 351 Gr. CF8
3	Wedge	A 216 Gr. WCB +13% Cr.	A 216 Gr. WCC ST6	A 352 Gr. LCB ST6	A 352 Gr. LCC ST6	A 217 Gr. C5 ST6	A 217 Gr. WC6 ST6	A 217 Gr. WC9 ST6	A 351 Gr. CF8 ST6
4	Seat Ring	A 105 + 13% Cr.	A 105 + ST6	A 350 Gr. LF2 + ST6	A 350 Gr. LF2 + ST6	A 182 Gr. F5 + ST6	A 182 Gr. F11 + ST6	A 182 Gr. F22 + ST6	A 182 Gr. F 304 + ST6
5	Gasket	SPW 304 + Grafoil Filler							
6	Stem	A 276 T 410							A 276 T 304
7	Back Seat	A 276 T 410							A 276 T 304
8	Gland	A 276 T 410							A 276 T 304
9	Gland Flange	A 105							A 351 Gr. CF8
10	Stud & Nut	A 193 Gr. B7 / A 194 Gr. 2H	A 193 Gr. B7 / A 194 Gr. 2H	A 320 Gr. L7 / A 194 Gr. 7	A 320 Gr. L7 / A 194 Gr. 7	A 193 Gr. B7 / A 194 Gr. 2H	A 193 Gr. B7 / A 194 Gr. 2H	A 193 Gr. B7 / A 194 Gr. 2H	A 193 Gr. B8 / A 194 Gr. 8
11	Eye bolt & Nut	Carbon Steel / A 194 Gr. 2H	Carbon Steel / A 194 Gr. 2H	Carbon Steel / A 194 Gr. 2H	Carbon Steel / A 194 Gr. 2H	Carbon Steel / A 194 Gr. 2H	Carbon Steel / A 194 Gr. 2H	Carbon Steel / A 194 Gr. 2H	Carbon Steel / A 194 Gr. 8
12	Gland Packing	Die Formed Flexible Grafoil Rings With Braided Top & Bottom Rings							
13	Yoke Sleeve	A 439 Type D2							

Sl. No.	Description	Stainless Steel					Duplex Stainless Steel		
		CF8	CF3	CF3M	CN7M	CF8C	6A	5A	4A
1	Body	A 351 Gr. CF8M	A 351 Gr. CF3	A 351 Gr. CF3M	A 351 Gr. CF7M	A 351 Gr. CF8C	A 995 Gr. 4A	A 995 Gr. 5A	A 995 Gr. 6A
2	Bonnet	A 351 Gr. CF8M	A 351 Gr. CF3	A 351 Gr. CF3M	A 351 Gr. CF7M	A 351 Gr. CF8C	A 995 Gr. 4A	A 995 Gr. 5A	A 995 Gr. 6A
3	Wedge	A 351 Gr. CF8M + ST6	A 351 Gr. CF3 + ST6	A 351 Gr. CF3M + ST6	A 351 Gr. CF7M + ST6	A 351 Gr. CF8C + ST6	A 995 Gr. 4A + ST6	A 995 Gr. 5A + ST6	A 995 Gr. 6A + ST6
4	Seat Ring	A 182 Gr. F304L + ST6	A 182 Gr. F304L + ST6	A 182 Gr. F316L + ST6	A 182 Gr. F20 + ST6	A 182 Gr. F347 + ST6	A 182 Gr. F51 + ST6	A 182 Gr. F53 + ST6	A 182 Gr. F55 + ST6
5	Gasket	SPW 316 + Grafoil Filler							
6	Stem	A 276 T 316	A 276 T 304L	A 276 T 316L	A182 Gr. F20	A182 Gr. F347	A182 Gr. F51	A182 Gr. F53	A182 Gr. F55
7	Back Seat	A 276 T 316	A 276 T 304L	A 276 T 316L	A182 Gr. F20	A182 Gr. F347	A182 Gr. F51	A182 Gr. F53	A182 Gr. F55
8	Gland	A 276 T 316	A 276 T 304L	A 276 T 316L	A182 Gr. F20	A182 Gr. F347	A182 Gr. F51	A182 Gr. F53	A182 Gr. F55
9	Gland Flange	A 351 Gr. CF8							
10	Stud & Nut	A 193 Gr. B8M / A 194 Gr. 8M							
11	Eye bolt & Nut	Carbon Steel / A 194 Gr. 8M	Carbon Steel / A 194 Gr. 8M	Carbon Steel / A 194 Gr. 8M	Carbon Steel / A 194 Gr. 8M	Carbon Steel / A 194 Gr. 8M	Carbon Steel / A 194 Gr. 8M	Carbon Steel / A 194 Gr. 8M	Carbon Steel / A 194 Gr. 8M
12	Gland Packing	Die Formed Flexible Grafoil Rings With Braided Top & Bottom Rings							
13	Yoke Sleeve	A 439 Type D2							

STANDARD MATERIAL OF CONSTRUCTION FOR GLOBE VALVE



Sl. No.	Description	Carbon Steel				Alloy Steel			SS
		WCB	WCC	LCB	LCC	C5	WC6	WC9	CF8
1	Body	A 216 Gr. WCB	A 216 Gr. WCC	A 352 Gr. LCB	A 352 Gr. LCC	A 217 Gr. C5	A 217 Gr. WC6	A 217 Gr. WC9	A 351 Gr. CF8
2	Bonnet	A 216 Gr. WCB	A 216 Gr. WCC	A 352 Gr. LCB	A 352 Gr. LCC	A 217 Gr. C5	A 217 Gr. WC6	A 217 Gr. WC9	A 351 Gr. CF8
3	Wedge	A 216 Gr. WCB +13% Cr.	A 216 Gr. WCC ST6	A 352 Gr. LCB ST6	A 352 Gr. LCC ST6	A 217 Gr. C5 ST6	A 217 Gr. WC6 ST6	A 217 Gr. WC9 ST6	A 351 Gr. CF8 ST6
4	Seat Ring	A 105 + 13% Cr.	A 105 + ST6	A 350 Gr. LF2 + ST6	A 350 Gr. LF2 + ST6	A 182 Gr. F5 + ST6	A 182 Gr. F11 + ST6	A 182 Gr. F22 + ST6	A 182 Gr. F 304 + ST6
5	Gasket	SPW 304 + Grafoil Filler							
6	Stem	A 276 T 410							
7	Back Seat	A 276 T 410							
8	Gland	A 276 T 410							
9	Gland Flange	A 105							
10	Stud & Nut	A 193 Gr. B7 / A 194 Gr. 2H	A 193 Gr. B7 / A 194 Gr. 2H	A 320 Gr. L7 / A 194 Gr. 7	A 320 Gr. L7 / A 194 Gr. 7	A 193 Gr. B7 / A 194 Gr. 2H	A 193 Gr. B7 / A 194 Gr. 2H	A 193 Gr. B7 / A 194 Gr. 2H	A 193 Gr. B8 / A 194 Gr. 8
11	Eye bolt & Nut	Carbon Steel / A 194 Gr. 2H	Carbon Steel / A 194 Gr. 2H	Carbon Steel / A 194 Gr. 2H	Carbon Steel / A 194 Gr. 2H	Carbon Steel / A 194 Gr. 2H	Carbon Steel / A 194 Gr. 2H	Carbon Steel / A 194 Gr. 2H	Carbon Steel / A 194 Gr. 8
12	Gland Packing	Die Formed Flexible Grafoil Rings With Braided Top & Bottom Rings							
13	Yoke Sleeve	A 439 Type D2							

Sl. No.	Description	Stainless Steel					Duplex Stainless Steel		
		CF8	CF3	CF3M	CN7M	CF8C	6A	5A	4A
1	Body	A 351 Gr. CF8M	A 351 Gr. CF3	A 351 Gr. CF3M	A 351 Gr. CF7M	A 351 Gr. CF8C	A 995 Gr. 4A	A 995 Gr. 5A	A 995 Gr. 6A
2	Bonnet	A 351 Gr. CF8M	A 351 Gr. CF3	A 351 Gr. CF3M	A 351 Gr. CF7M	A 351 Gr. CF8C	A 995 Gr. 4A	A 995 Gr. 5A	A 995 Gr. 6A
3	Wedge	A 351 Gr. CF8M + ST6	A 351 Gr. CF3 + ST6	A 351 Gr. CF3M + ST6	A 351 Gr. CF7M + ST6	A 351 Gr. CF8C + ST6	A 995 Gr. 4A + ST6	A 995 Gr. 5A + ST6	A 995 Gr. 6A + ST6
4	Seat Ring	A 182 Gr. F304L + ST6	A 182 Gr. F304L + ST6	A 182 Gr. F316L + ST6	A 182 Gr. F20 + ST6	A 182 Gr. F347 + ST6	A 182 Gr. F51 + ST6	A 182 Gr. F53 + ST6	A 182 Gr. F55 + ST6
5	Gasket	SPW 316 + Grafoil Filler							
6	Stem	A 276 T 316	A 276 T 304L	A 276 T 316L	A182 Gr. F20	A182 Gr. F347	A182 Gr. F51	A182 Gr. F53	A182 Gr. F55
7	Back Seat	A 276 T 316	A 276 T 304L	A 276 T 316L	A182 Gr. F20	A182 Gr. F347	A182 Gr. F51	A182 Gr. F53	A182 Gr. F55
8	Gland	A 276 T 316	A 276 T 304L	A 276 T 316L	A182 Gr. F20	A182 Gr. F347	A182 Gr. F51	A182 Gr. F53	A182 Gr. F55
9	Gland Flange	A 351 Gr. CF8							
10	Stud & Nut	A 193 Gr. B8M / A 194 Gr. 8M							
11	Eye bolt & Nut	Carbon Steel / A 194 Gr. 8M	Carbon Steel / A 194 Gr. 8M	Carbon Steel / A 194 Gr. 8M	Carbon Steel / A 194 Gr. 8M	Carbon Steel / A 194 Gr. 8M	Carbon Steel / A 194 Gr. 8M	Carbon Steel / A 194 Gr. 8M	Carbon Steel / A 194 Gr. 8M
12	Gland Packing	Die Formed Flexible Grafoil Rings With Braided Top & Bottom Rings							
13	Yoke Sleeve	A 439 Type D2							



STANDARD MATERIAL OF CONSTRUCTION FOR SWING CHECK VALVE

Sl. No.	Description	Carbon Steel				Alloy Steel			SS
		WCB	WCC	LCB	LCC	C5	WC6	WC9	CF8
1	Body	A 216 Gr. WCB	A 216 Gr. WCC	A 352 Gr. LCB	A 352 Gr. LCC	A 217 Gr. C5	A 217 Gr. WC6	A 217 Gr. WC9	A 351 Gr. CF8
2	Cover	A 216 Gr. WCB	A 216 Gr. WCC	A 352 Gr. LCB	A 352 Gr. LCC	A 217 Gr. C5	A 217 Gr. WC6	A 217 Gr. WC9	A 351 Gr. CF8
3	Disc	A 216 Gr. WCB +13% Cr.	A 216 Gr. WCC + ST6	A 352 Gr. LCB + ST6	A 352 Gr. LCC + ST6	A 217 Gr. C5 + ST6	A 217 Gr. WC6 + ST6	A 217 Gr. WC9 + ST6	A 351 Gr. CF8 + ST6
4	Seat Ring	A 105 + 13% Cr.	A 105 + ST6	A 350 Gr. LF2 + ST6	A 350 Gr. LF2 + ST6	A 182 Gr. F5 + ST6	A 182 Gr. F11 + ST6	A 182 Gr. F22 + ST6	A 182 Gr. F 304 + ST6
5	Gasket	SPW 304 + Grafoil Filler							
6	Hinge	A 276 T 410							
7	Bracket	A 216 Gr. WCB	A 216 Gr. WCC	A 352 Gr. LCB	A 352 Gr. LCC	A 217 Gr. C5	A 217 Gr. WC6	A 217 Gr. WC9	A 351 Gr. CF8
8	Hinge Pin	A 276 T 410							
9	Disc Washer	A 276 T 410							
10	Disc Nut	A 276 T 410							
11	Split pin	A 276 T 410							
12	Stud & Nut	A 193 Gr. B7 / A 194 Gr. 2H	A 193 Gr. B7 / A 194 Gr. 2H	A 320 Gr. L7 / A 194 Gr. 7	A 320 Gr. L7 / A 194 Gr. 7	A 193 Gr. B7 / A 194 Gr. 2H	A 193 Gr. B7 / A 194 Gr. 2H	A 193 Gr. B7 / A 194 Gr. 2H	A 193 Gr. B8 / A 194 Gr. 8

Sl. No.	Description	Stainless Steel					Duplex Stainless Steel		
		CF8	CF3	CF3M	CN7M	CF8C	6A	5A	4A
1	Body	A 351 Gr. CF8M	A 351 Gr. CF3	A 351 Gr. CF3M	A 351 Gr. CF7M	A 351 Gr. CF8C	A 995 Gr. 4A	A 995 Gr. 5A	A 995 Gr. 6A
2	Cover	A 351 Gr. CF8M	A 351 Gr. CF3	A 351 Gr. CF3M	A 351 Gr. CF7M	A 351 Gr. CF8C	A 995 Gr. 4A	A 995 Gr. 5A	A 995 Gr. 6A
3	Disc	A 351 Gr. CF8M + ST6	A 351 Gr. CF3 + ST6	A 351 Gr. CF3M + ST6	A 351 Gr. CF7M + ST6	A 351 Gr. CF8C + ST6	A 995 Gr. 4A + ST6	A 995 Gr. 5A + ST6	A 995 Gr. 6A + ST6
4	Seat Ring	A 182 Gr. F316 + ST6	A 182 Gr. F304L + ST6	A 182 Gr. F316L + ST6	A 182 Gr. F20 + ST6	A 182 Gr. F347 + ST6	A 182 Gr. F51 + ST6	A 182 Gr. F53 + ST6	A 182 Gr. F55 + ST6
5	Gasket	SPW 316 + Grafoil Filler							
6	Hinge	A 276 T 316	A 276 T 304L	A 276 T 316L	A182 Gr. F20	A182 Gr. F347	A182 Gr. F51	A182 Gr. F53	A182 Gr. F55
7	Bracket	A 351 Gr. CF8M	A 351 Gr. CF3	A 351 Gr. CF3M	A 351 Gr. CF7M	A 351 Gr. CF8C	A 995 Gr. 4A	A 995 Gr. 5A	A 995 Gr. 6A
8	Hinge Pin	A 276 T 316	A 276 T 304L	A 276 T 316L	A182 Gr. F20	A182 Gr. F347	A182 Gr. F51	A182 Gr. F53	A182 Gr. F55
9	Disc Washer	A 276 T 316	A 276 T 304L	A 276 T 316L	A182 Gr. F20	A182 Gr. F347	A182 Gr. F51	A182 Gr. F53	A182 Gr. F55
10	Disc Nut	A 276 T 316	A 276 T 304L	A 276 T 316L	A182 Gr. F20	A182 Gr. F347	A182 Gr. F51	A182 Gr. F53	A182 Gr. F55
11	Split pin	A 276 T 316	A 276 T 304L	A 276 T 316L	A182 Gr. F20	A182 Gr. F347	A182 Gr. F51	A182 Gr. F53	A182 Gr. F55
12	Stud & Nut	A 193 Gr. B8M / A 194 Gr. 8M							



GATE VALVE (GTB)



Kent Gate valves with its unique features have been used in oil & gas, power, petrochemical and fertilizers industry. Our gate valves conforms to API 600 Design with various material and wedges totally condensed with metal to metal tight shut-off. Valves are designed with smooth unhindered and are free of pockets, cavities and depressions in the seat area. The valves are available with OS & Y configurations. The valve has only two moving internal parts the gate and the stem. In resilient seat gate valves, dual rubber seal is formed between the rubber encapsulated resilient wedge and the valve body to guarantee drop-tight shut-off every time. The combination of true compression and dynamic wedging of the gate is created with smooth sliding and avoiding shearing or other wear -inducing action. The valve will seal upto 2500 Class working pressure with the flow in either direction as per API 598. The valve features an unobstructed thru-conduit flow path for full flow capacity.





GATE VALVE BOLTED BONNET

150 # (API 600 / BS 1414)

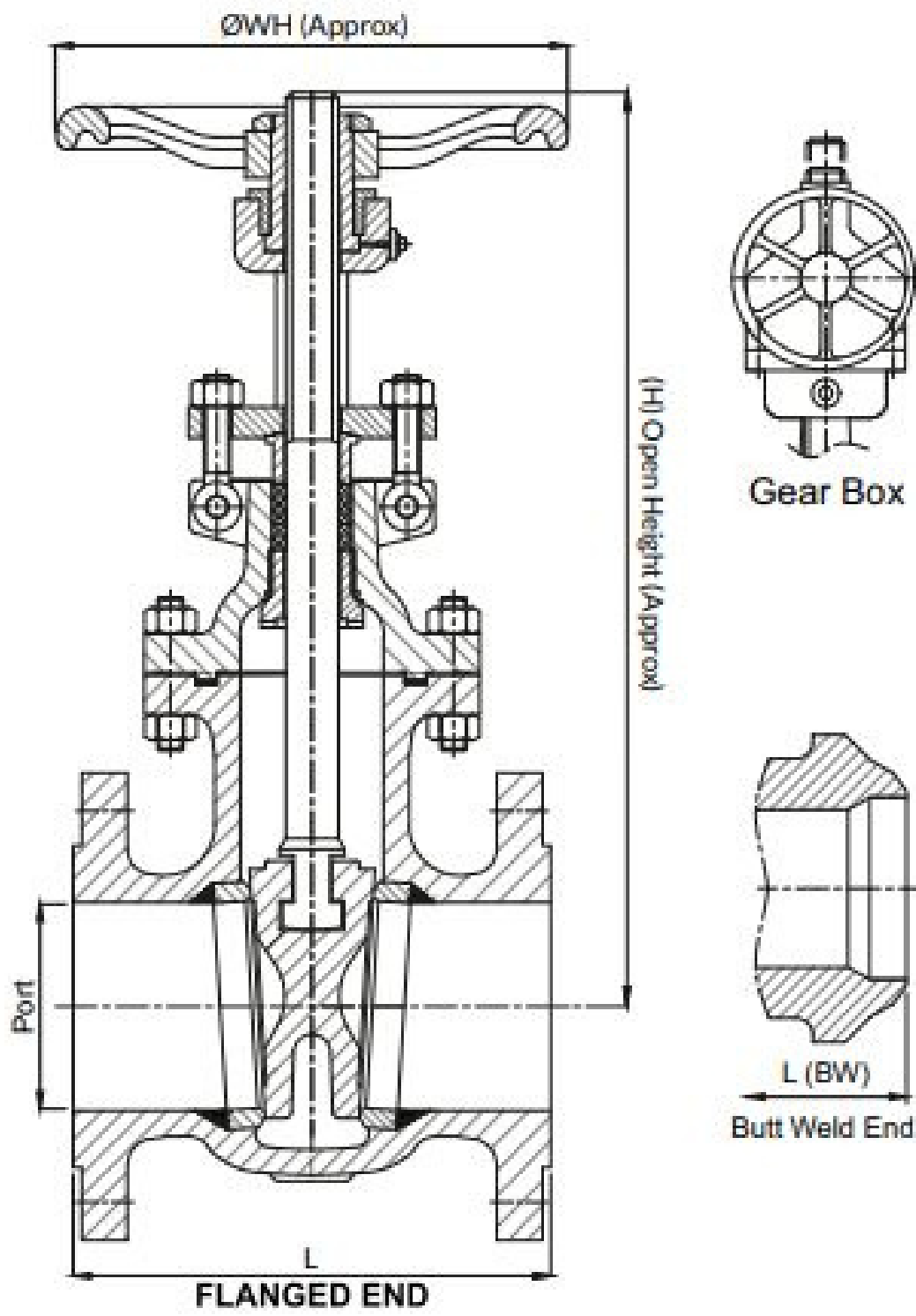

SL. NO.	DESCRIPTION	TYPICAL MATERIAL
1	Body	ASTM A 216 Gr. WCB
2	Bonnet	ASTM A 216 Gr. WCB
3	Wedge	ASTM A 216 Gr. WCB + 13% Cr. Facing
4	Seat ring	ASTM A 105 + HF
5	Gasket	Spiral wound SS304 with grafoil filler
6	Stem	ASTM A 276 T 410
7	Back seat	ASTM A 276 T 410
8	Gland	ASTM A 276 T 410
9	Gland flange	ASTM A 105
10	Stud & Nut	ASTM A 193 Gr. B7 / ASTM A 194 Gr. 2H
11	Eye Bolt & Nut	Carbon Steel / ASTM A 194 Gr. 2H
12	Gland Packing	Die formed flexible grafoil rings with braided top and bottom rings
13	Yoke Sleeve	ASTM A 439 Type D2
14	Hand Wheel	Malleable Iron

Typical Example – Assembly of gate valve with standard bill of material.

DIMENSION TABLE, CLASS 150								
SIZE		PORT	(L) - FACE TO FACE		WH	(H) - Open Height	APPROX. WT. (kg)	
NPS	DN		FL	BW			FL	BW
2	50	51	178	216	200	378	21	19
3	80	76	203	282	250	482	35	27
4	100	102	229	305	300	575	52	42
6	150	152	267	403	350	786	85	77
8	200	203	292	419	350	975	136	120
10	250	254	330	457	400	1162	210	199
12	300	305	356	502	450	1410	298	275
14	350	337	381	572	GO	1550	420	365
16	400	387	406	610	GO	1715	525	490
18	450	438	432	660	GO	1920	680	650
20	500	489	457	711	GO	2215	900	840
24	600	591	508	813	GO	2545	1370	1295

26" & above size design as per client requirement.

GO : Gear Operated , FL : Flanged , BW : Butt weld , WH : Handwheel
As Kent Valve continuously endeavour to improve our products, the data given herein is subject to change.

GATE VALVE BOLTED BONNET

300 # (API 600 / BS 1414)

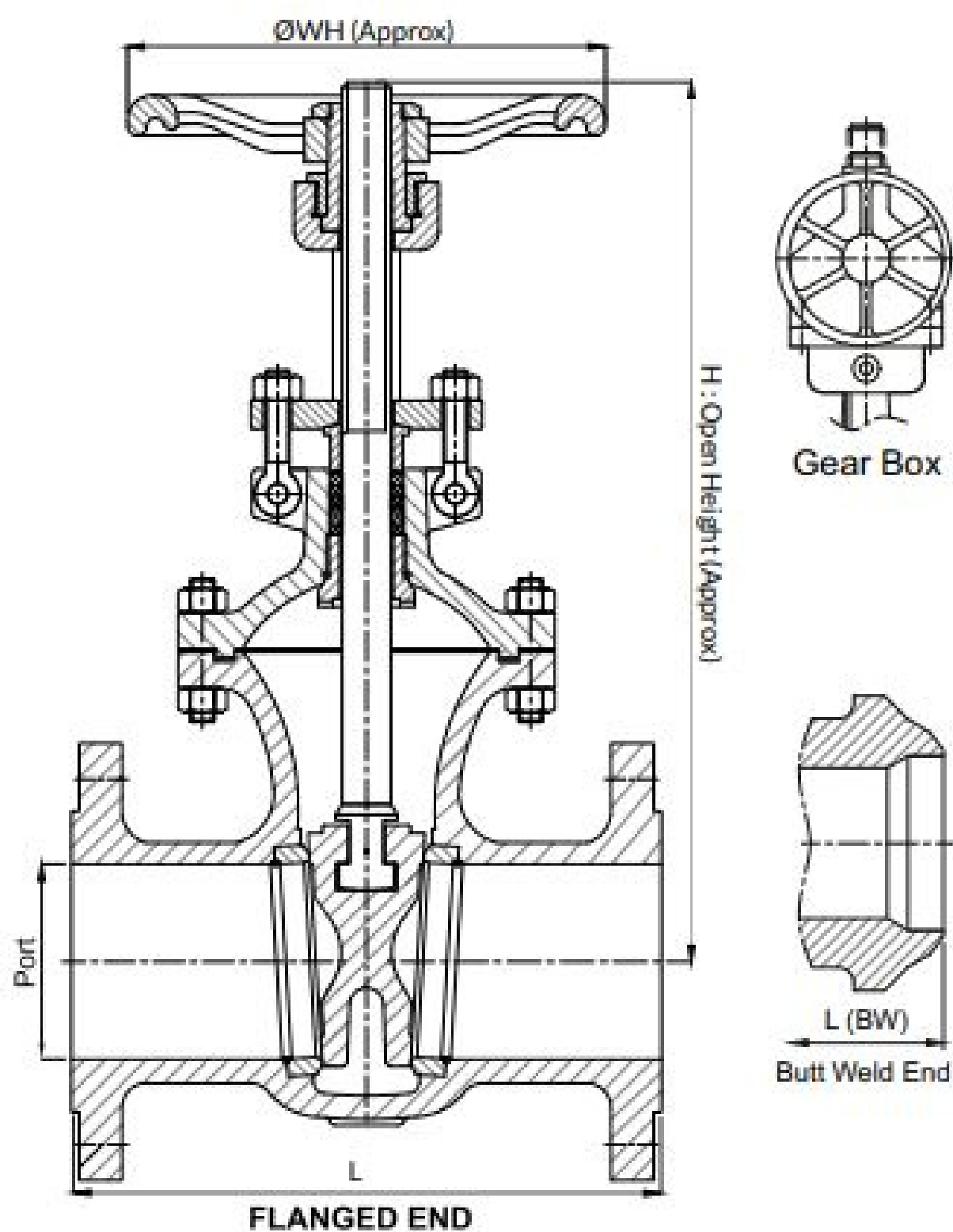

SL. NO.	DESCRIPTION	TYPICAL MATERIAL
1	Body	ASTM A 216 Gr. WCB
2	Bonnet	ASTM A 216 Gr. WCB
3	Wedge	ASTM A 216 Gr. WCB + 13% Cr. Facing
4	Seat ring	ASTM A 105 + HF
5	Gasket	Spiral wound SS304 with grafoil filler
6	Stem	ASTM A 276 T 410
7	Back seat	ASTM A 276 T 410
8	Gland	ASTM A 276 T 410
9	Gland flange	ASTM A 105
10	Stud & Nut	ASTM A 193 Gr. B7 / ASTM A 194 Gr. 2H
11	Eye Bolt & Nut	Carbon Steel / ASTM A 194 Gr. 2H
12	Gland Packing	Die formed flexible grafoil rings with braided top and bottom rings
13	Yoke Sleeve	ASTM A 439 Type D2
14	Hand Wheel	Malleable Iron

Typical Example – Assembly of gate valve with standard bill of material.

DIMENSION TABLE, CLASS 300								
SIZE		PORT	(L) - FACE TO FACE		WH	(H) - Open Height	APPROX. WT. (kg)	
NPS	DN		FL	BW			FL	BW
2	50	51	216	216	200	378	25	23
3	80	76	282	282	250	482	50	41
4	100	102	305	305	300	595	74	55
6	150	152	403	403	350	835	150	112
8	200	203	419	419	400	1025	216	190
10	250	254	457	457	450	1265	342	287
12	300	305	502	502	GO	1500	465	400
14	350	337	762	762	GO	1610	750	620
16	400	387	838	838	GO	1835	1070	885
18	450	432	914	914	GO	2135	1285	1095
20	500	483	991	991	GO	2245	1675	1535
24	600	584	1143	1143	GO	2615	2350	2085

26" & above size design as per client requirement.

GO : Gear Operated , FL : Flanged , BW : Butt weld , WH : Handwheel
As Kent Valve continuously endeavour to improve our products, the data given herein is subject to change.



GATE VALVE BOLTED BONNET 600 # (API 600 / BS 1414)

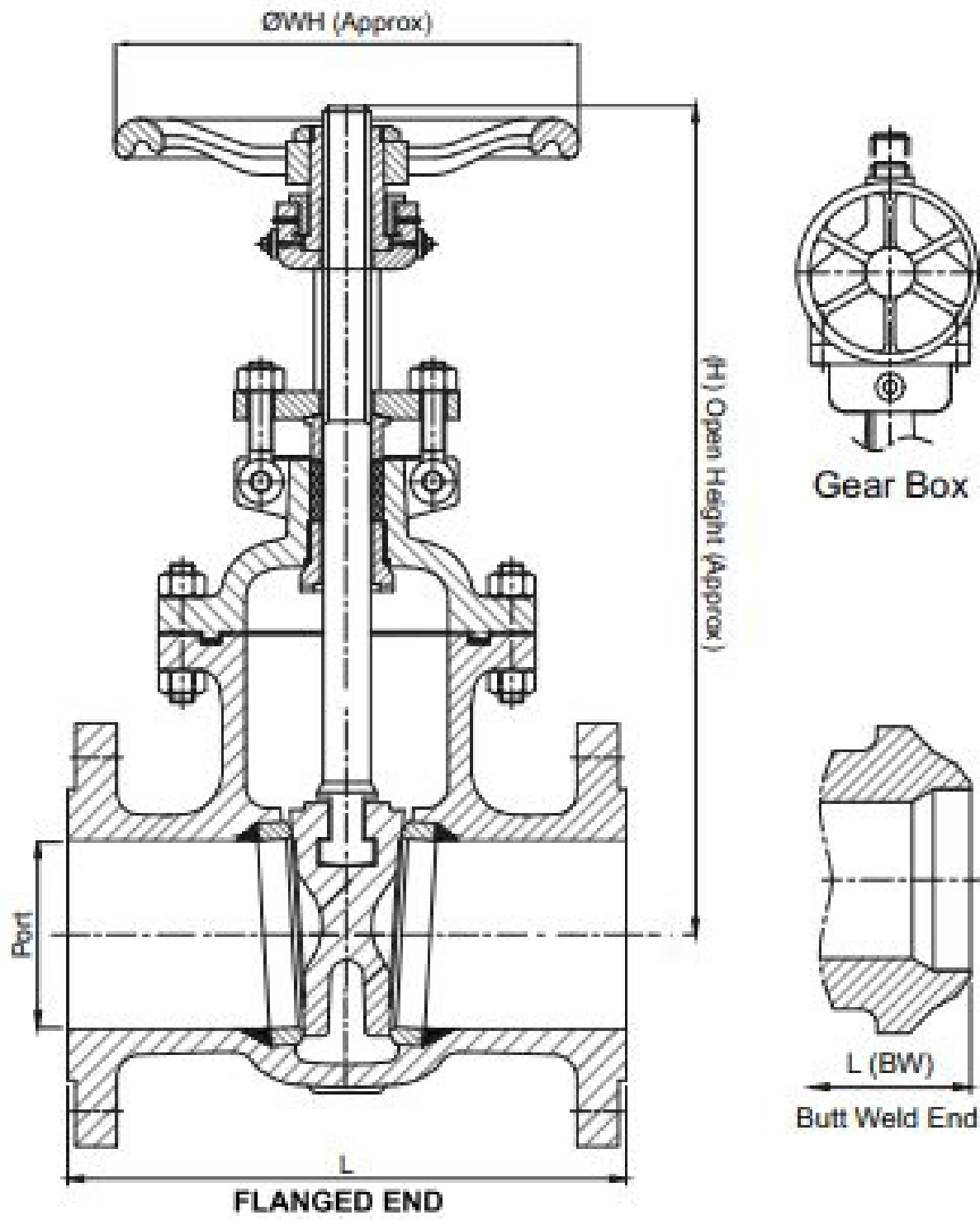

SL. NO.	DESCRIPTION	TYPICAL MATERIAL
1	Body	ASTM A 216 Gr. WCB
2	Bonnet	ASTM A 216 Gr. WCB
3	Wedge	ASTM A 216 Gr. WCB + 13% Cr. Facing
4	Seat ring	ASTM A 105 + HF
5	Gasket	Spiral wound SS304 with grafoil filler
6	Stem	ASTM A 276 T 410
7	Back seat	ASTM A 276 T 410
8	Gland	ASTM A 276 T 410
9	Gland flange	ASTM A 105
10	Stud & Nut	ASTM A 193 Gr. B7 / ASTM A 194 Gr. 2H
11	Eye Bolt & Nut	Carbon Steel / ASTM A 194 Gr. 2H
12	Gland Packing	Die formed flexible grafoil rings with braided top and bottom rings
13	Yoke Sleeve	ASTM A 439 Type D2
14	Hand Wheel	Malleable Iron

Typical Example – Assembly of gate valve with standard bill of material.

DIMENSION TABLE, CLASS 600								
SIZE		PORT	(L) - FACE TO FACE		WH	(H) - Open Height	APPROX. WT. (kg)	
NPS	DN		FL	BW			FL	BW
2	50	51	292	292	200	390	38	30
3	80	76	356	356	250	515	64	52
4	100	102	432	432	310	635	125	102
6	150	152	559	559	450	805	235	210
8	200	200	660	660	450	1010	405	355
10	250	248	787	787	GO	1245	652	558
12	300	299	838	838	GO	1465	1050	945
14	350	327	889	889	GO	1505	1360	1240
16	400	375	991	991	GO	1885	1905	1610
18	450	419	1092	1092	GO	2015	2160	1895
20	500	464	1194	1194	GO	2848	2350	2065
24	600	559	1397	1397	GO	3050	3930	3210

GO : Gear Operated , FL : Flanged , BW : Butt weld , WH : Handwheel
As Kent Valve continuously endeavour to improve our products, the data given herein is subject to change.

GATE VALVE BOLTED BONNET 900 # (API 600 / BS 1414)

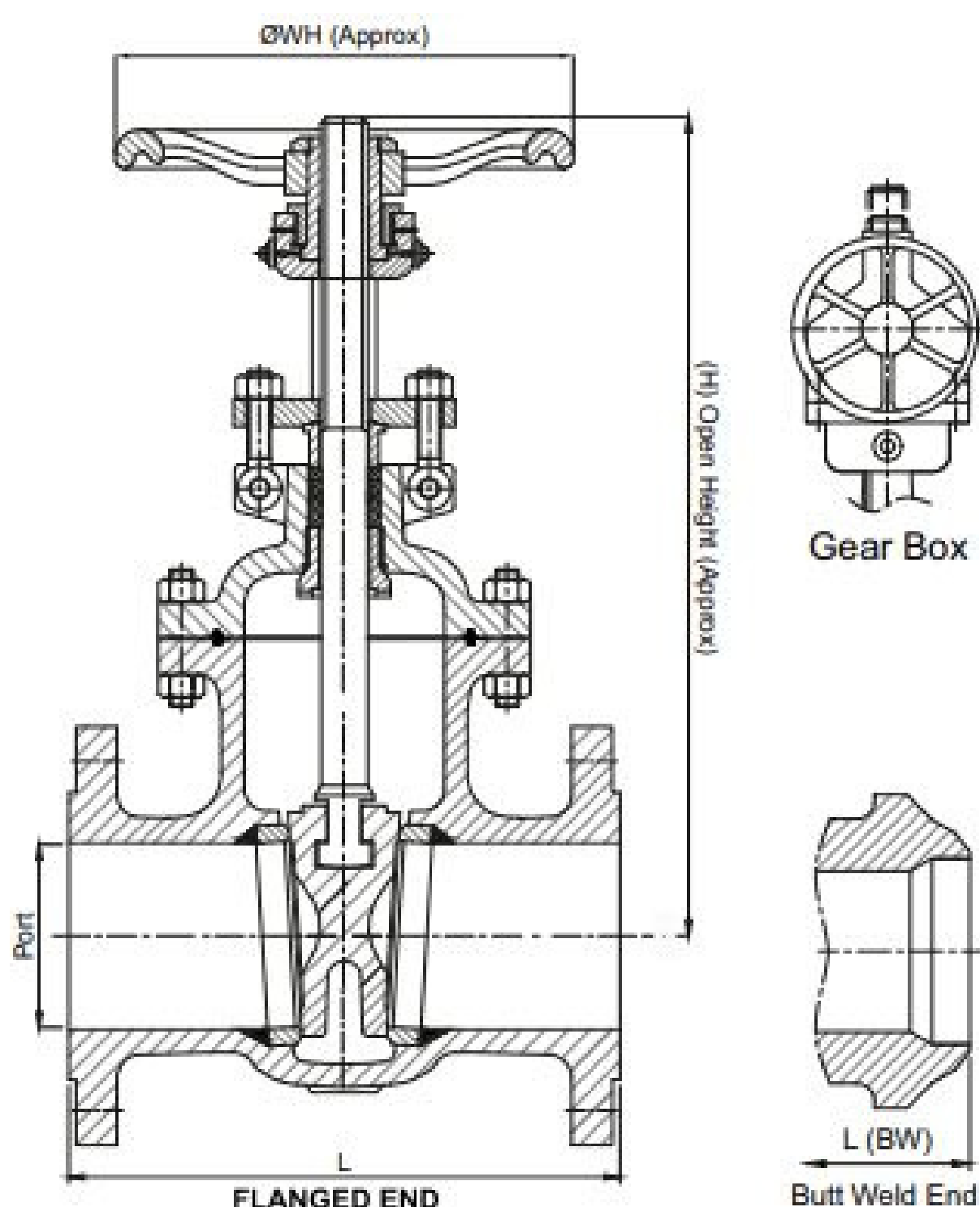

SL. NO.	DESCRIPTION	TYPICAL MATERIAL
1	Body	ASTM A 216 Gr. WCB
2	Bonnet	ASTM A 216 Gr. WCB
3	Wedge	ASTM A 216 Gr. WCB + 13% Cr. Facing
4	Seat ring	ASTM A 105 + HF
5	Gasket RTJ	Soft Iron / SS 316
6	Stem	ASTM A 276 T 410
7	Back seat	ASTM A 276 T 410
8	Gland	ASTM A 276 T 410
9	Gland flange	ASTM A 105
10	Stud & Nut	ASTM A 193 Gr. B7 / ASTM A 194 Gr. 2H
11	Eye Bolt & Nut	Carbon Steel / ASTM A 194 Gr. 2H
12	Gland Packing	Die formed flexible grafoil rings with braided top and bottom rings
13	Yoke Sleeve	ASTM A 439 Type D2
14	Hand Wheel	Malleable Iron

Typical Example – Assembly of gate valve with standard bill of material.

DIMENSION TABLE, CLASS 900									
SIZE		PORT	(L) - FACE TO FACE			WH	(H) - Open Height	APPROX. WT. (kg)	
NPS	DN		FL	BW	RTJ			FL/ RTJ	BW
2	50	-	-	-	-	-	-	-	30
3	80	73	381	381	384	400	700	135	115
4	100	99	457	457	460	560	800	210	195
6	150	146	610	610	613	620	1100	450	390
8	200	191	737	737	740	GO	1500	785	680
10	250	238	838	838	841	GO	1800	1165	1040
12	300	283	965	965	968	GO	2000	1700	1595

GO : Gear Operated , FL : Flanged , BW : Butt weld , RTJ : Ring Type Joint , WH : Handwheel For RTJ flange dimension refers to standard ASME B16.5 For 2" valves, dimension refer class 1500 dimension table.

As Kent Valve continuously endeavour to improve our products, the data given herein is subject to change.



GATE VALVE BOLTED BONNET

1500 # (API 600 / BS 1414)

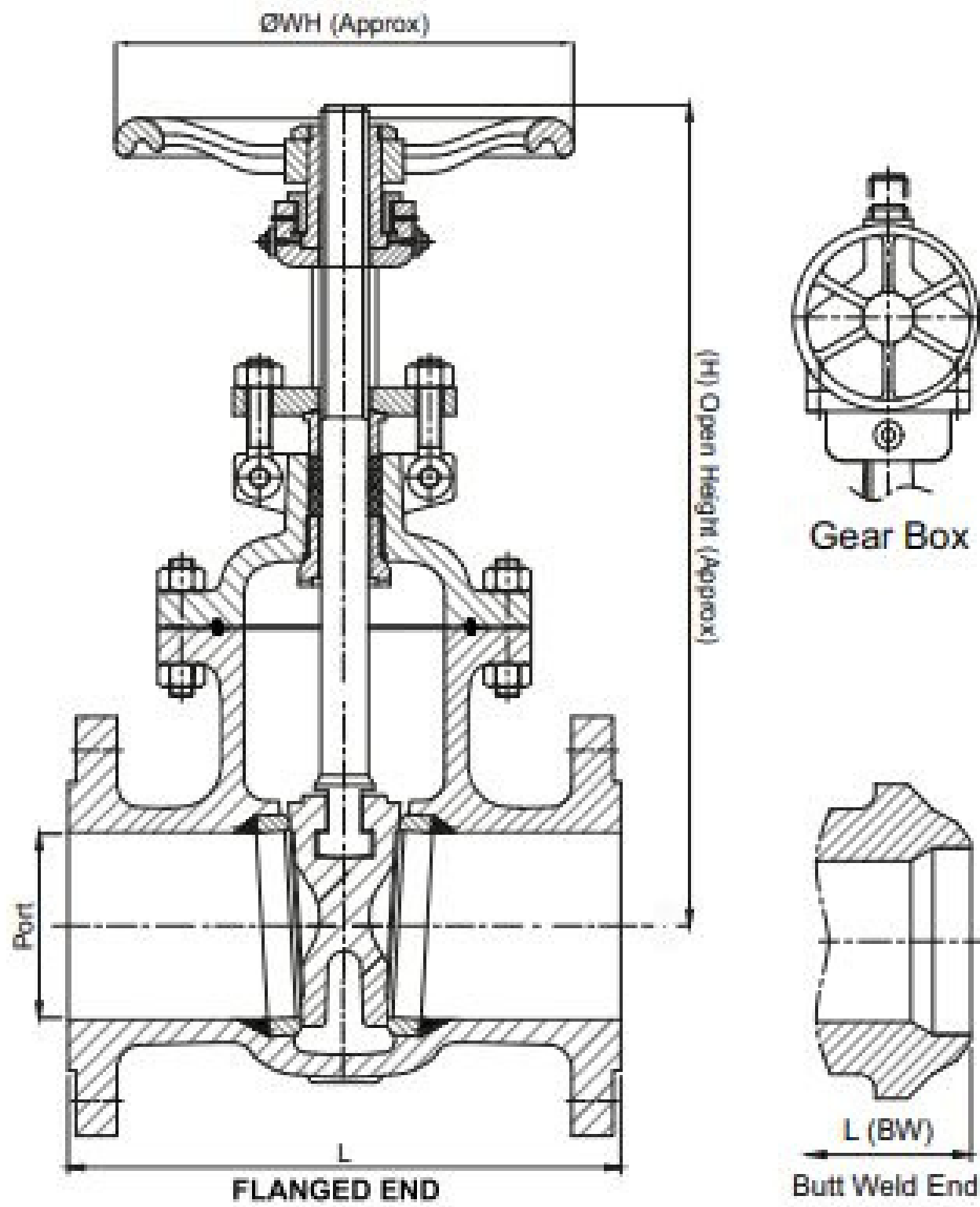

SL. NO.	DESCRIPTION	TYPICAL MATERIAL
1	Body	ASTM A 216 Gr. WCB
2	Bonnet	ASTM A 216 Gr. WCB
3	Wedge	ASTM A 216 Gr. WCB + 13% Cr. Facing
4	Seat ring (Seal Weld)	ASTM A 105 + HF
5	Gasket RTJ	Soft Iron / SS 316
6	Stem	ASTM A 276 T 410
7	Back seat	ASTM A 276 T 410
8	Gland	ASTM A 276 T 410
9	Gland flange	ASTM A 105
10	Stud & Nut	ASTM A 193 Gr. B7 / ASTM A 194 Gr. 2H
11	Eye Bolt & Nut	Carbon Steel / ASTM A 194 Gr. 2H
12	Gland Packing	Die formed flexible grafoil rings with braided top and bottom rings
13	Yoke Sleeve	ASTM A 439 Type D2
14	Hand Wheel	Malleable Iron

Typical Example – Assembly of gate valve with standard bill of material.

DIMENSION TABLE, CLASS 1500									
SIZE		PORT	(L) - FACE TO FACE			WH	(H) - Open Height	APPROX. WT. (kg)	
NPS	DN		FL	BW	RTJ			FL/ RTJ	BW
2	50	48	368	368	371	350	590	130	115
3	80	70	470	470	473	400	750	220	180
4	100	92	546	546	549	560	865	340	240
6	150	136	705	705	711	GO	1195	675	585
8	200	178	832	832	842	GO	1450	1250	1125
10	250	222	991	991	1001	GO	1650	2065	1765
12	300	263	1130	1130	1146	GO	1850	2965	2590

Valves above 1500 class, information can be furnished on request

GO : Gear Operated , FL : Flanged , BW : Butt weld , RTJ : Ring Type Joint , WH : Handwheel For RTJ flange dimension refers to standard ASME B16.5 For 2" valves, dimension refer class 1500 dimension table.

As Kent Valve continuously endeavour to improve our products, the data given herein is subject to change.



GLOBE VALVE (GBB)



Kent Globe Valves with its unique features have been used in oil & gas, power, petrochemical and fertilizers industry. Our Globe Valves conforms to BS 1813/ API 623 design with various material with plugs totally condensed with metal to metal tight shut-off. Body guided plug in globe valves (all sizes/classes) provides plug stability and avoids vibrations of the plug-plug nut assembly. Non-rotating rising stem design in globe valves (2" and above) yields a 20 - 30% reduction in valve torque vice-a-versa the rotating rising stem globe valves body guided plug accurately mates the hard-faced surface of the plug (hard-faced with 13% Cr, CoCr alloy, SS 316, or Monel) with the surface of the body seat, which is ground and lapped to a smooth surface finish.





GLOBE VALVE BOLTED BONNET

150 # (API 623 / BS 1873)

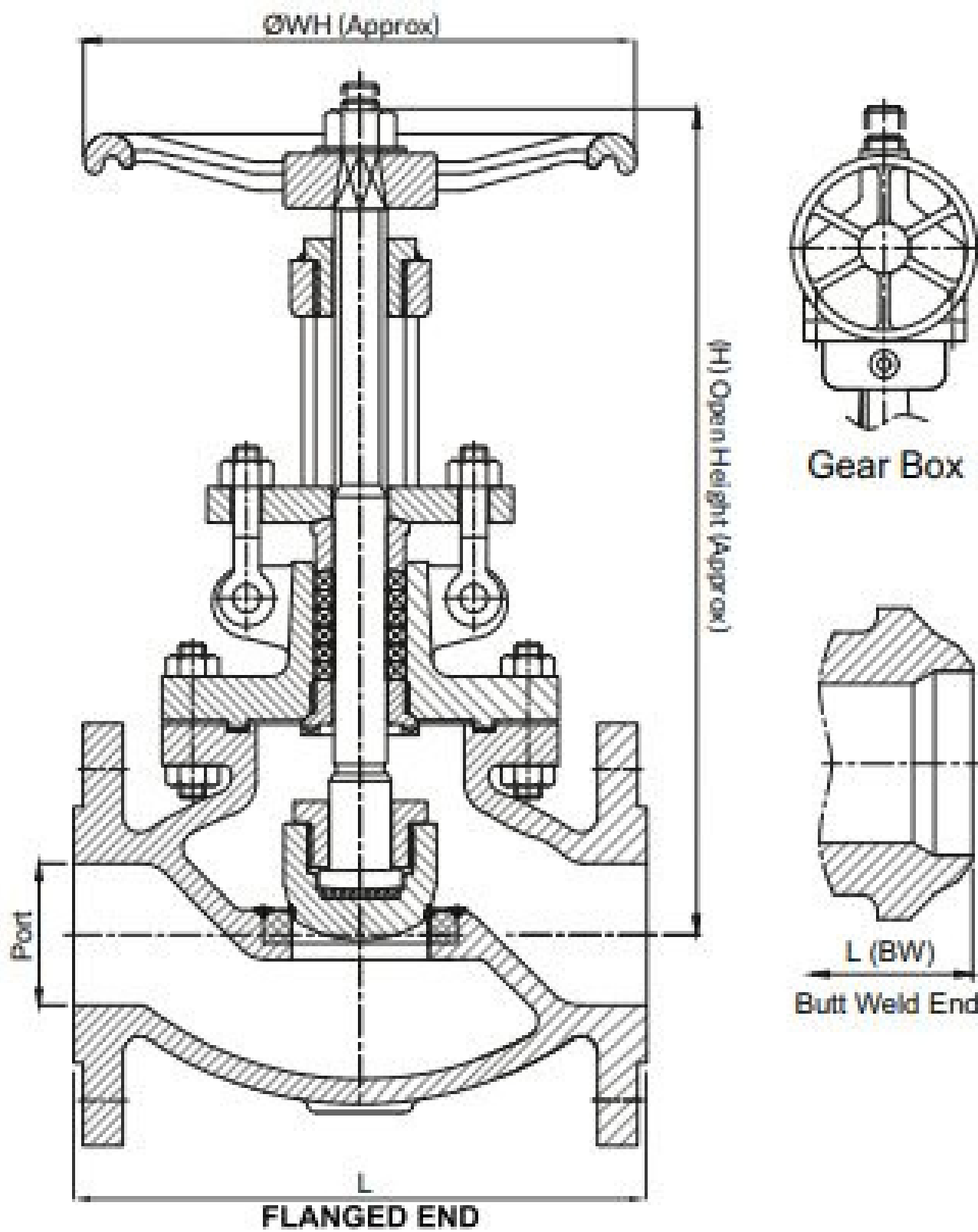

SL. NO.	DESCRIPTION	TYPICAL MATERIAL
1	Body	ASTM A 216 Gr. WCB
2	Bonnet	ASTM A 216 Gr. WCB
3	Plug	ASTM A 216 Gr. WCB + 13% Cr. Facing
4	Plug Nut	ASTM A 276 T 410
5	Seat ring (Seal Weld)	ASTM A 105 + HF
6	Stem	ASTM A 276 T 410
7	Back seat	ASTM A 276 T 410
8	Gland	ASTM A 276 T 410
9	Stem Nut	ASTM A 439 Type D2
10	Gland Packing	Die formed flexible grafoil rings with braided top and bottom rings
11	Gasket	Spiral wound SS304 with grafoil filler
12	Stud & Nut	ASTM A 193 Gr. B7 / ASTM A 194 Gr. 2H
13	Hand Wheel	Malleable Iron
14	Gland Flange	ASTM A 105
15	Eye bolt & Nut	Carbon Steel / ASTM A 194 Gr. 2H
16	Thrust Washer	ASTM A 276 T 410

Typical Example – Assembly of globe valve with standard bill of material.

DIMENSION TABLE, CLASS 150								
SIZE		PORT	(L) - FACE TO FACE		WH	(H) - Open Height	APPROX. WT. (kg)	
NPS	DN		FL	BW			FL	BW
2	50	51	203	203	200	335	22	20
3	80	76	241	241	250	421	40	-
4	100	102	292	292	300	477	68	62
6	150	152	406	406	350	575	120	110
8	200	203	495	495	400	680	210	195
10	250	254	622	622	500	895	340	320
12	300	305	698	698	600	1215	500	470
14	350	337	787	787	GO	-	-	-
16	400	387	914	914	GO	-	-	-

18" & above size design as per client requirement.

GO : Gear Operated , FL : Flanged , BW : Butt weld , WH : Handwheel
As Kent Valve continuously endeavours to improve our products, the data given herein is subject to change.

LOBE VALVE BOLTED BONNET

300 # (API 623 / BS 1873)

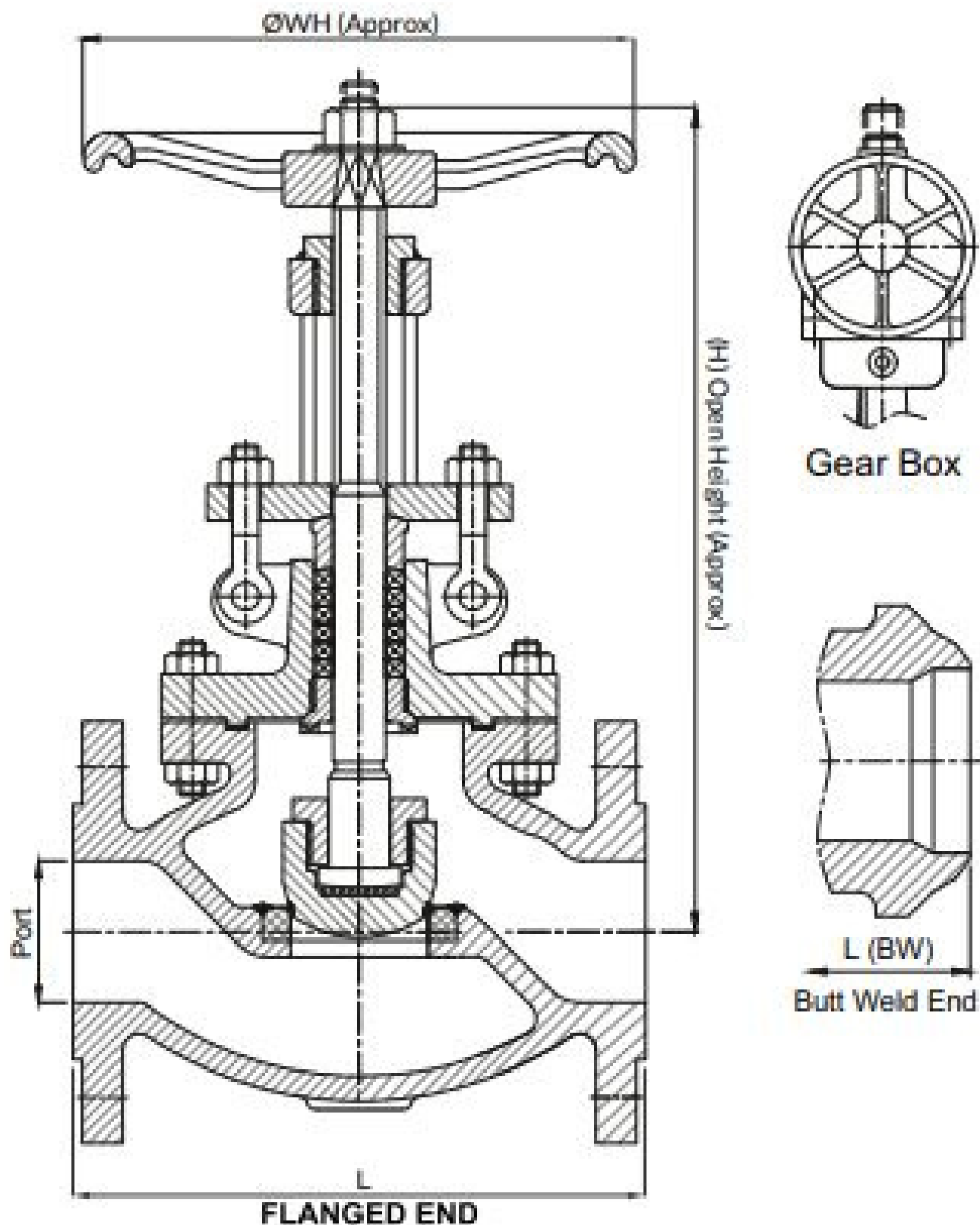

SL. NO.	DESCRIPTION	TYPICAL MATERIAL
1	Body	ASTM A 216 Gr. WCB
2	Bonnet	ASTM A 216 Gr. WCB
3	Plug	ASTM A 216 Gr. WCB + 13% Cr. Facing
4	Plug Nut	ASTM A 276 T 410
5	Seat ring (Seal Weld)	ASTM A 105 + HF
6	Stem	ASTM A 276 T 410
7	Back seat	ASTM A 276 T 410
8	Gland	ASTM A 276 T 410
9	Stem Nut	ASTM A 439 Type D2
10	Gland Packing	Die formed flexible grafoil rings with braided top and bottom rings
11	Gasket	Spiral wound SS304 with grafoil filler
12	Stud & Nut	ASTM A 193 Gr. B7 / ASTM A 194 Gr. 2H
13	Hand Wheel	Malleable Iron
14	Gland Flange	ASTM A 105
15	Eye bolt & Nut	Carbon Steel / ASTM A 194 Gr. 2H
16	Thrust Washer	ASTM A 276 T 410

Typical Example – Assembly of globe valve with standard bill of material.

DIMENSION TABLE, CLASS 300								
SIZE		PORT	(L) - FACE TO FACE		WH	(H) - Open Height	APPROX. WT. (kg)	
NPS	DN		FL	BW			FL	BW
2	50	51	267	267	200	349	35	30
3	80	76	318	318	250	430	60	55
4	100	102	356	356	350	486	95	85
6	150	152	444	444	450	618	190	170
8	200	203	559	559	560	937	335	295
10	250	254	622	622	600	949	520	475
12	300	305	711	711	GO	995	705	640

14" & above size design as per client requirement.

GO : Gear Operated , FL : Flanged , BW : Butt weld , WH : Handwheel
 As Kent Valve continuously endeavours to improve our products, the data given herein is subject to change.



GLOBE VALVE BOLTED BONNET

600 # (API 623 / BS 1873)

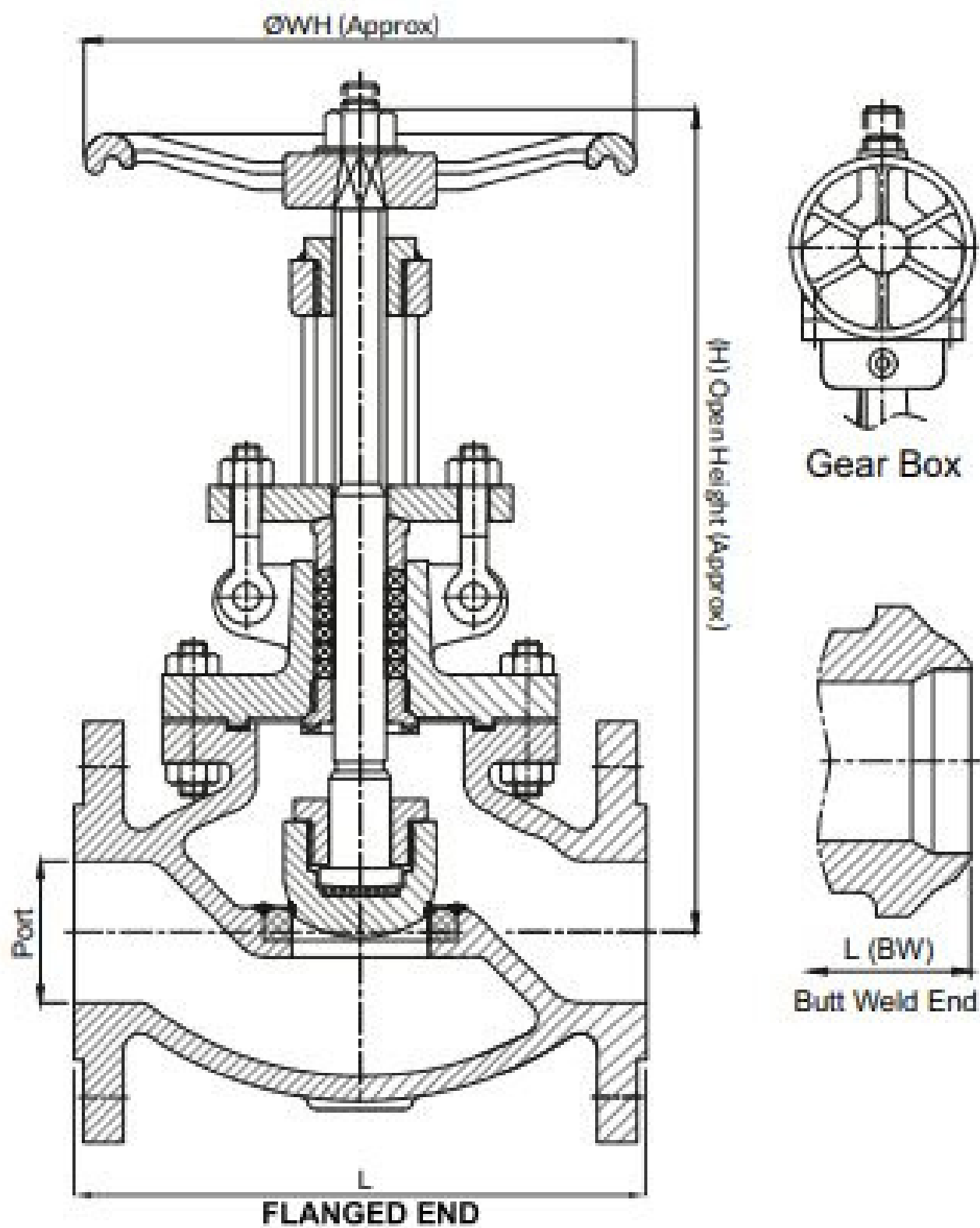
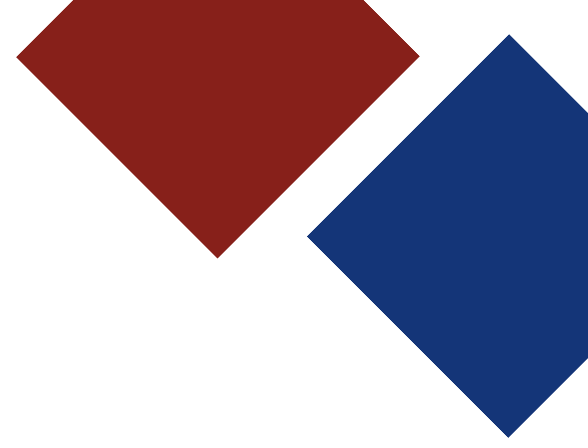

SL. NO.	DESCRIPTION	TYPICAL MATERIAL
1	Body	ASTM A 216 Gr. WCB
2	Bonnet	ASTM A 216 Gr. WCB
3	Plug	ASTM A 216 Gr. WCB + 13% Cr. Facing
4	Plug Nut	ASTM A 276 T 410
5	Seat ring (Seal Weld)	ASTM A 105 + HF
6	Stem	ASTM A 276 T 410
7	Back seat	ASTM A 276 T 410
8	Gland	ASTM A 276 T 410
9	Stem Nut	ASTM A 439 Type D2
10	Gland Packing	Die formed flexible grafoil rings with braided top and bottom rings
11	Gasket	Spiral wound SS304 with grafoil filler
12	Stud & Nut	ASTM A 193 Gr. B7 / ASTM A 194 Gr. 2H
13	Hand Wheel	Malleable Iron
14	Gland Flange	ASTM A 105
15	Eye bolt & Nut	Carbon Steel / ASTM A 194 Gr. 2H
16	Thrust Washer	ASTM A 276 T 410

Typical Example – Assembly of globe valve with standard bill of material.

DIMENSION TABLE, CLASS 600								
SIZE		PORT	(L) - FACE TO FACE		WH	(H) - Open Height	APPROX. WT. (kg)	
NPS	DN		FL	BW			FL	BW
2	50	51	292	292	250	400	45	40
3	80	76	356	356	350	560	75	60
4	100	102	432	432	450	595	140	120
6	150	152	559	559	560	840	260	195
8	200	200	660	660	GO	950	540	465
10	250	248	787	787	GO	1285	755	655
12	300	298	838	838	GO	1560	1083	895

14" & above size design as per client requirement.

GO : Gear Operated , FL : Flanged , BW : Butt weld , WH : Handwheel
As Kent Valve continuously endeavours to improve our products, the data given herein is subject to change.

GLOBE VALVE BOLTED BONNET

900 # (API 623 / BS 1873)

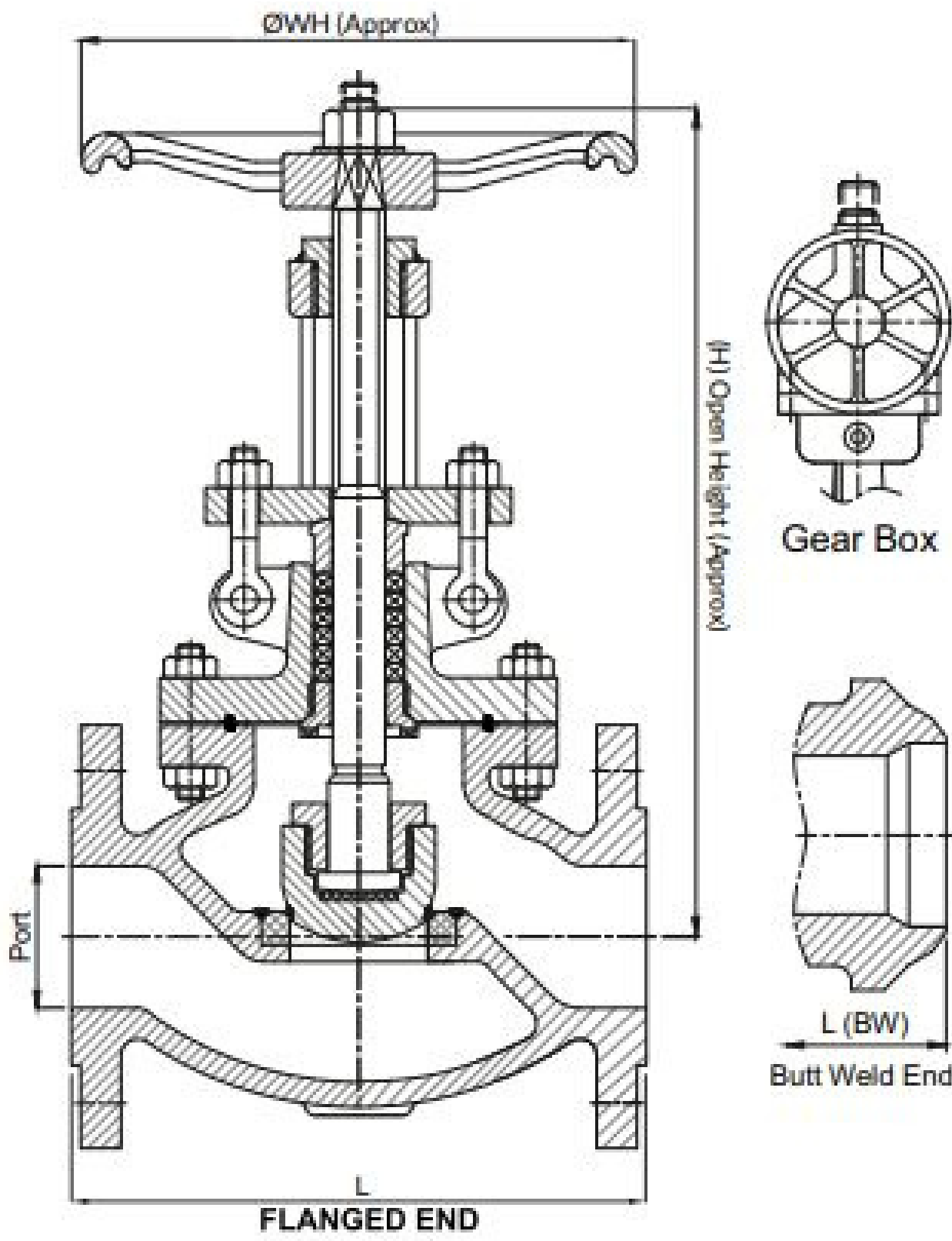

SL. NO.	DESCRIPTION	TYPICAL MATERIAL
1	Body	ASTM A 216 Gr. WCB
2	Bonnet	ASTM A 216 Gr. WCB
3	Plug	ASTM A 216 Gr. WCB + 13% Cr. Facing
4	Plug Nut	ASTM A 276 T 410
5	Seat ring (Seal Weld)	ASTM A 105 + HF
6	Stem	ASTM A 276 T 410
7	Back seat	ASTM A 276 T 410
8	Gland	ASTM A 276 T 410
9	Stem Nut	ASTM A 439 Type D2
10	Gland Packing	Die formed flexible grafoil rings with braided top and bottom rings
11	Gasket	Spiral wound SS304 with grafoil filler
12	Stud & Nut	ASTM A 193 Gr. B7 / ASTM A 194 Gr. 2H
13	Hand Wheel	Malleable Iron
14	Gland Flange	ASTM A 105
15	Eye bolt & Nut	Carbon Steel / ASTM A 194 Gr. 2H
16	Thrust Washer	ASTM A 276 T 410

Typical Example – Assembly of globe valve with standard bill of material.

DIMENSION TABLE, CLASS 900									
SIZE		PORT	(L) - FACE TO FACE			WH	(H) - Open Height	APPROX. WT. (kg)	
NPS	DN		FL	BW	RTJ			FL./RTJ	BW
2	50	48	368	368	371	350	-	-	-
3	80	73	381	381	384	450	700	135	115
4	100	98	457	457	460	560	800	210	185
6	150	146	610	610	613	GO	1100	430	390
8	200	190	737	737	740	GO	-	-	-
10	250	238	838	838	841	GO	-	-	-
12	300	283	965	965	968	GO	-	-	-

GO : Gear Operated , FL : Flanged , BW : Butt weld , WH : Handwheel
 As Kent Valve continuously endeavours to improve our products, the data given herein is subject to change.



GLOBE VALVE BOLTED BONNET

1500 # (API 623 / BS 1873)

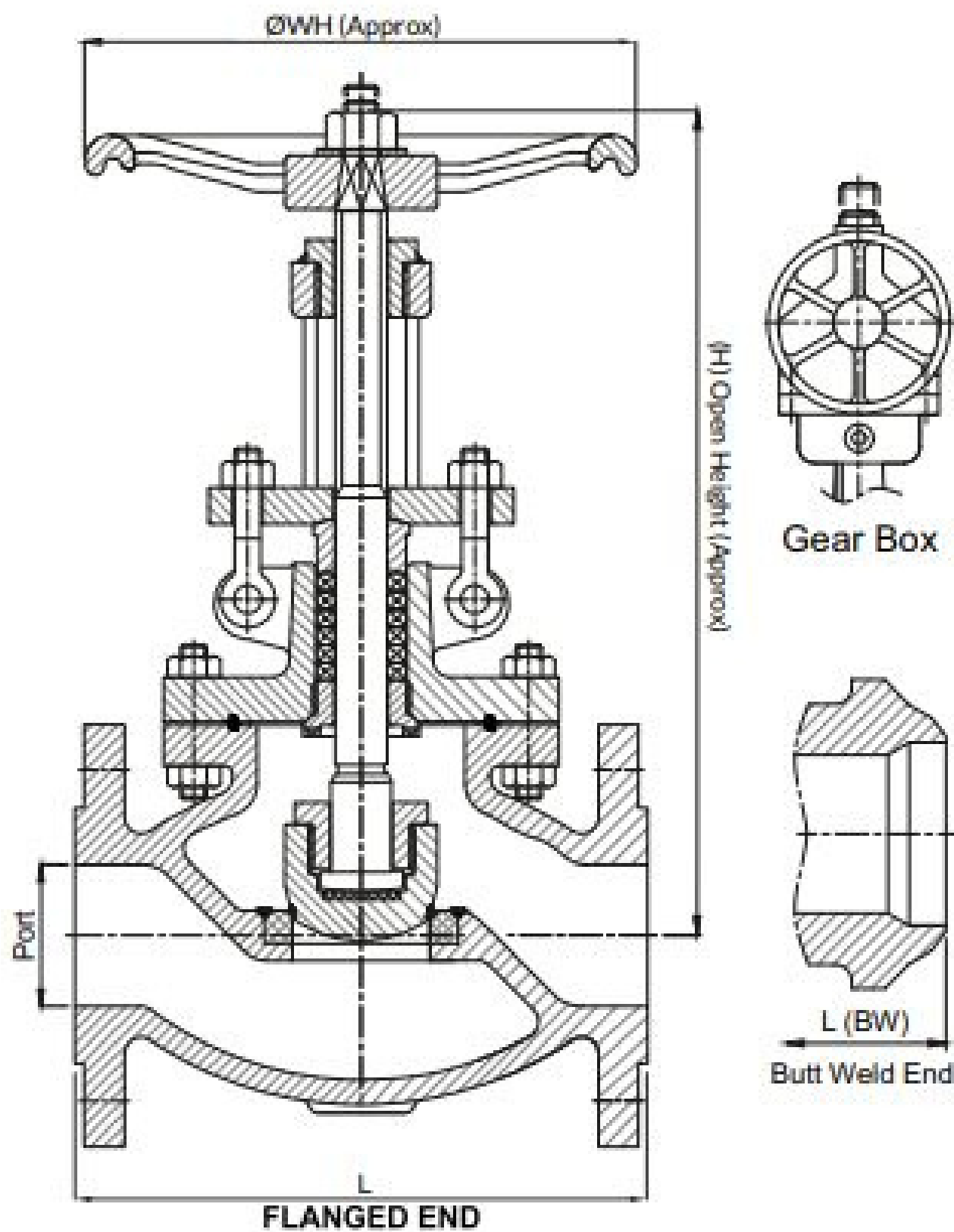

SL. NO.	DESCRIPTION	TYPICAL MATERIAL
1	Body	ASTM A 216 Gr. WCB
2	Bonnet	ASTM A 216 Gr. WCB
3	Plug	ASTM A 216 Gr. WCB + 13% Cr. Facing
4	Plug Nut	ASTM A 276 T 410
5	Seat ring (Seal Weld)	ASTM A 105 + HF
6	Stem	ASTM A 276 T 410
7	Back seat	ASTM A 276 T 410
8	Gland	ASTM A 276 T 410
9	Stem Nut	ASTM A 439 Type D2
10	Gland Packing	Die formed flexible grafoil rings with braided top and bottom rings
11	Gasket	Spiral wound SS304 with grafoil filler
12	Stud & Nut	ASTM A 193 Gr. B7 / ASTM A 194 Gr. 2H
13	Hand Wheel	Malleable Iron
14	Gland Flange	ASTM A 105
15	Eye bolt & Nut	Carbon Steel / ASTM A 194 Gr. 2H
16	Thrust Washer	ASTM A 276 T 410

Typical Example – Assembly of globe valve with standard bill of material.

DIMENSION TABLE, CLASS 150									
SIZE		PORT	(L) - FACE TO FACE			WH	(H) - Open Height	APPROX. WT. (kg)	
NPS	DN		FL	BW	RTJ			FL/RTJ	BW
2	50	48	368	368	371	350	595	125	-
3	80	70	470	470	473	450	695	250	-
4	100	92	546	546	549	GO	910	335	-
6	150	137	705	705	711	GO	1015	585	-
8	200	178	832	832	842	GO	1145	825	-
10	250	222	991	991	1001	GO	1550	1385	-
12	300	264	1130	1130	1146	GO	-	-	-

Valves above 1500 class, information can be furnished on request.

GO : Gear Operated , FL : Flanged , BW : Butt weld , WH : Handwheel
 As Kent Valve continuously endeavours to improve our products, the data given herein is subject to change.



SWING CHECK VALVE (SCB)



Kent Check Valves with its unique features have been used in oil & gas, power, petrochemical and fertilizer Industry. The body geometry is designed as the result of stress calculations to achieve the most regular distribution of the internal forces due to pressure action. The cover is bolted type or pressure seal type for the higher pressures. The cover is produced with material similar to the body material. The disk is produced with material similar to the body material. A welding overlay with high hardness is deposited on the contact surface. The dash pot arrangement dampens the closing of disc for check valve can be provided on clients requirement.





SWING CHECK VALVE BOLTED COVER

150 # (API 6D / BS 1868)

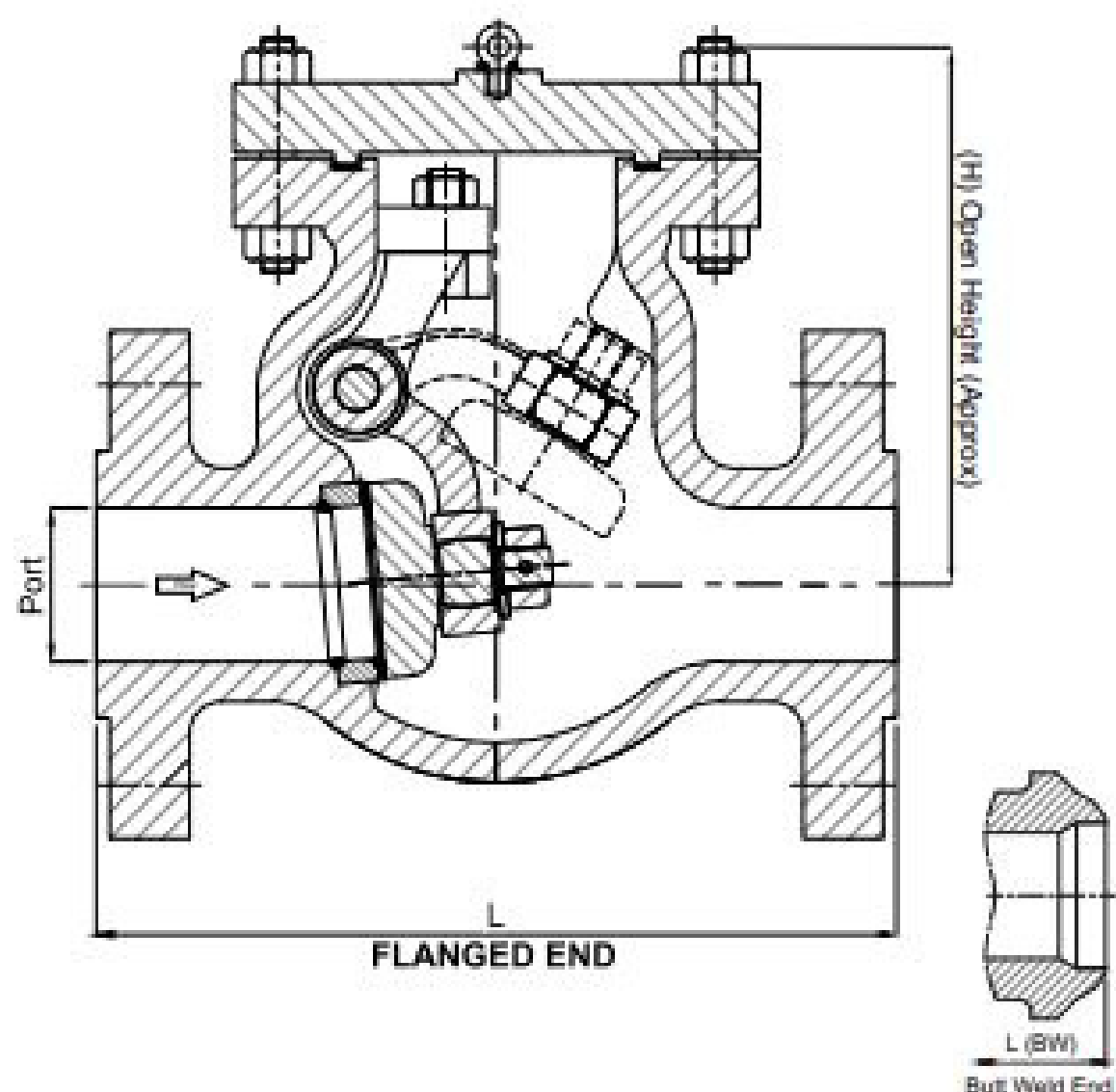

SL. NO.	DESCRIPTION	TYPICAL MATERIAL
1	Body	ASTM A 216 Gr. WCB
2	Seat ring (Seal Weld)	ASTM A 216 Gr. WCB + 13% Cr. Facing
3	Disc	ASTM A 216 Gr. WCB + 13% Cr. Facing
4	Hinge	ASTM A 216 Gr. WCB
5	Disc Washer	13% Cr. Steel
6	Disc Nut	SS304
7	Disc Nut pin	13% Cr. Steel
8	Hinge pin	13% Cr. Steel
9	Bracket	ASTM A 216 Gr. WCB
10	Gasket	Spiral wound SS304 with grafoil filler
11	Cover	ASTM A 216 Gr. WCB
12	Stud & Nut	ASTM A 193 Gr. B7 / ASTM A 194 Gr. 2H

- ★ Lifting Lug 6" & above
- ★ Drain Plug on request

DIMENSION TABLE, CLASS 150							
SIZE		PORT	(L) - FACE TO FACE		(H) - Open Height	APPROX. WT. (kg)	
NPS	DN		FL	BW		FL	BW
2	50	51	203	203	135	16	13
3	80	76	241	241	165	28	22
4	100	102	292	292	190	42	34
6	150	152	356	356	230	75	69
8	200	203	495	495	285	135	122
10	250	254	622	622	335	194	183
12	300	305	698	698	365	300	272
14	350	337	787	787	415	467	401
16	400	387	864	864	470	560	-
18	450	438	978	978	535	725	-
20	500	489	978	978	600	870	-
24	600	591	1295	1295	675	1370	-

26" & above size design as per client requirement.

FL : Flanged , BW : Butt weld
 As Kent Valve continuously endeavour to improve our products, the data given herein is subject to change.

SWING CHECK VALVE BOLTED COVER

300 # (API 6D / BS 1868)

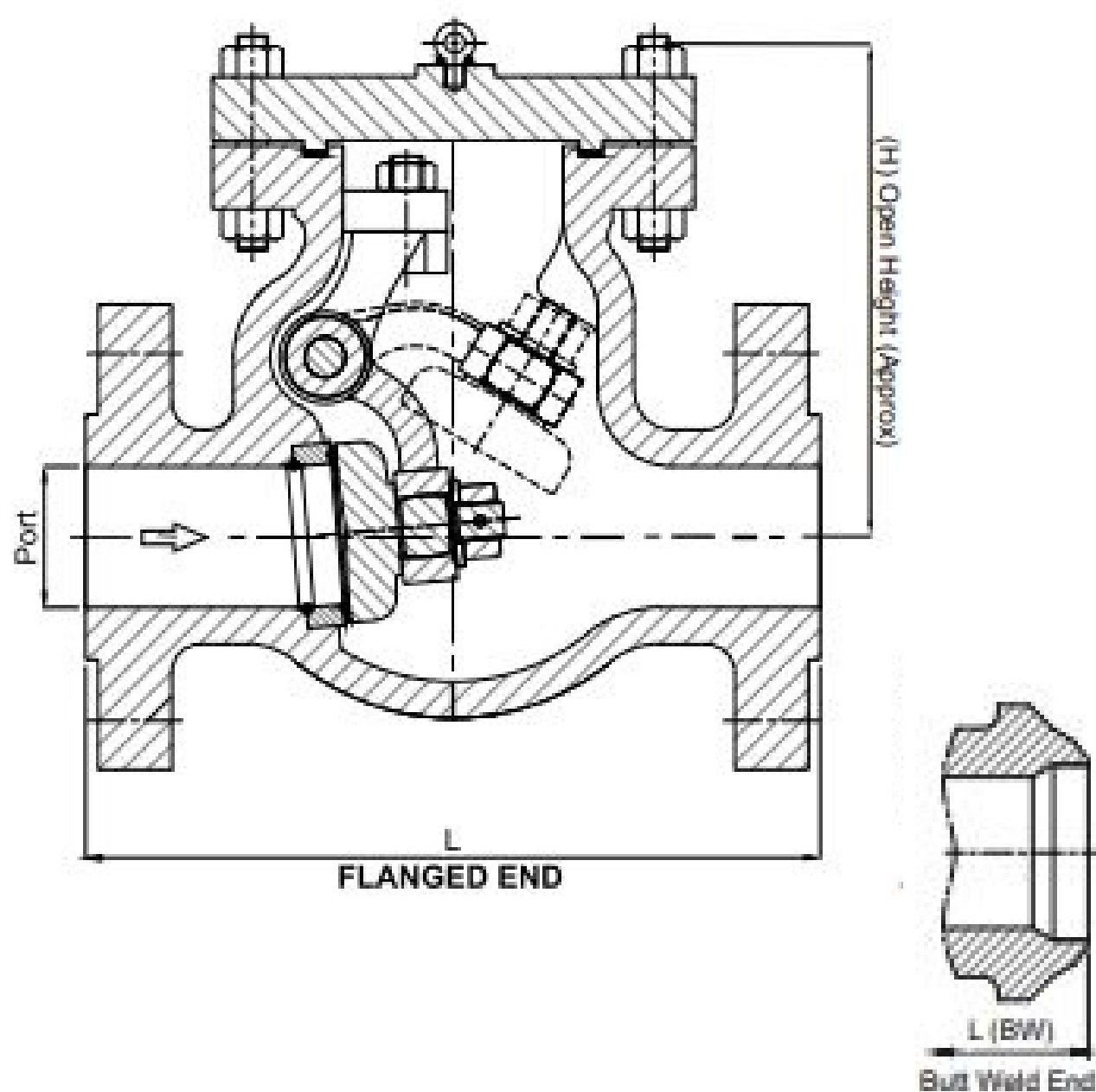

SL. NO.	DESCRIPTION	TYPICAL MATERIAL
1	Body	ASTM A 216 Gr. WCB
2	Seat ring (Seal Weld)	ASTM A 216 Gr. WCB + 13% Cr. Facing
3	Disc	ASTM A 216 Gr. WCB + 13% Cr. Facing
4	Hinge	ASTM A 216 Gr. WCB
5	Disc Washer	13% Cr. Steel
6	Disc Nut	SS304
7	Disc Nut pin	13% Cr. Steel
8	Hinge pin	13% Cr. Steel
9	Bracket	ASTM A 216 Gr. WCB
10	Gasket	Spiral wound SS304 with grafoil filler
11	Cover	ASTM A 216 Gr. WCB
12	Stud & Nut	ASTM A 193 Gr. B7 / ASTM A 194 Gr. 2H

- ★ Lifting Lug 4" & above
- ★ Drain Plug on request

DIMENSION TABLE, CLASS 300							
SIZE		PORT	(L) - FACE TO FACE		(H) - Open Height	APPROX. WT. (kg)	
NPS	DN		FL	BW		FL	BW
2	50	51	267	267	140	24	19
3	80	76	318	318	175	45	36
4	100	102	356	356	205	70	56
6	150	152	444	444	250	130	129
8	200	203	533	533	315	220	210
10	250	254	622	622	355	335	284
12	300	305	711	711	395	470	378
14	350	337	838	838	465	645	556
16	400	387	864	864	530	865	747
18	450	432	978	978	610	1100	900
20	500	483	1016	1016	655	1280	-
24	600	584	1346	1346	745	1700	-

26" & above size design as per client requirement.

FL : Flanged , BW : Butt weld
 As Kent Valve continuously endeavour to improve our products, the data given herein is subject to change.



SWING CHECK VALVE BOLTED COVER

600 # (API 6D / BS 1868)

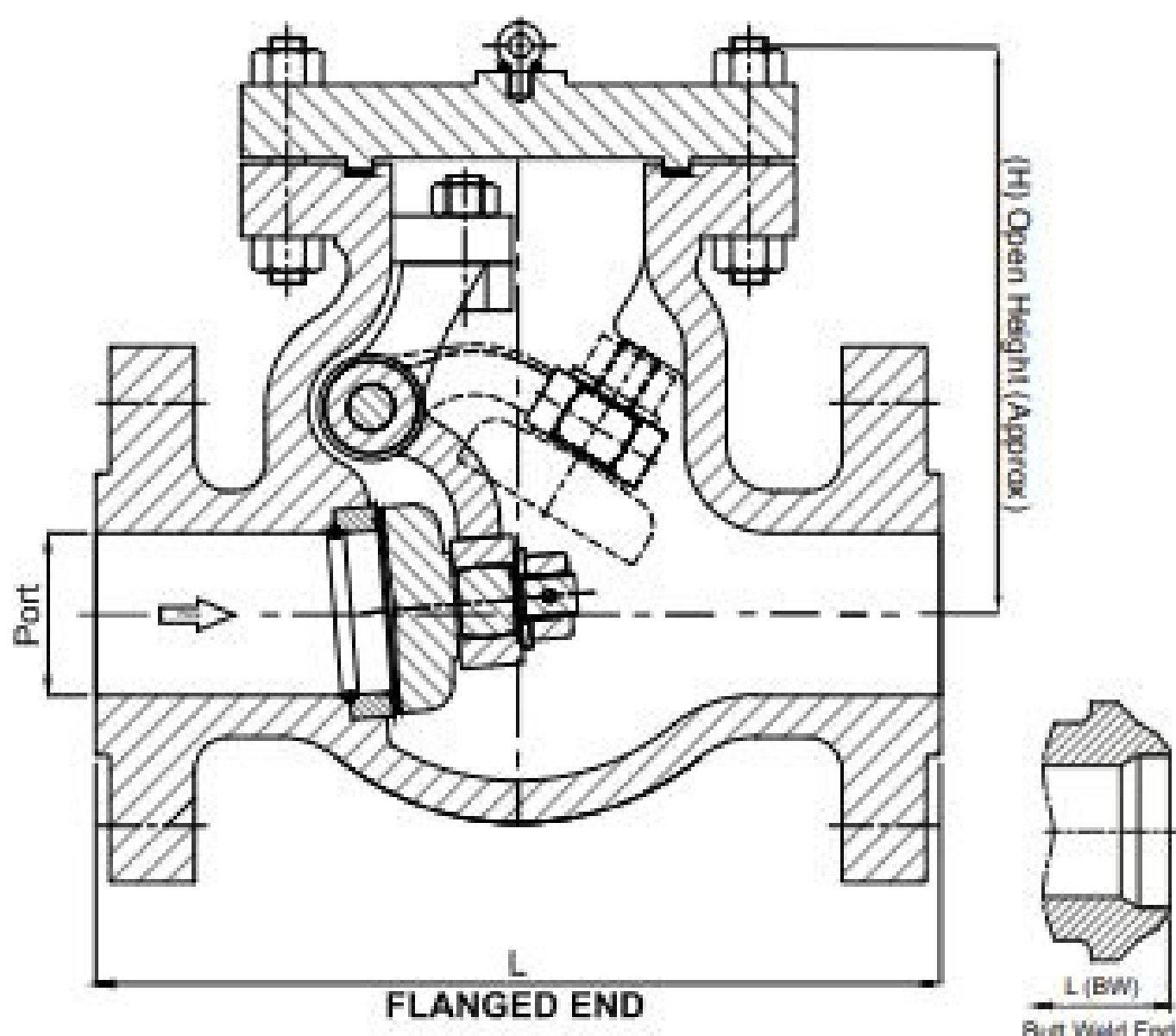

SL. NO.	DESCRIPTION	TYPICAL MATERIAL
1	Body	ASTM A 216 Gr. WCB
2	Seat ring (Seal Weld)	ASTM A 216 Gr. WCB + 13% Cr. Facing
3	Disc	ASTM A 216 Gr. WCB + 13% Cr. Facing
4	Hinge	ASTM A 216 Gr. WCB
5	Disc Washer	13% Cr. Steel
6	Disc Nut	SS304
7	Disc Nut pin	13% Cr. Steel
8	Hinge pin	13% Cr. Steel
9	Bracket	ASTM A 216 Gr. WCB
10	Gasket	Spiral wound SS304 with grafoil filler
11	Cover	ASTM A 216 Gr. WCB
12	Stud & Nut	ASTM A 193 Gr. B7 / ASTM A 194 Gr. 2H

- ★ Lifting Lug 3" & above
- ★ Drain Plug on request

DIMENSION TABLE, CLASS 600							
SIZE		PORT	(L) - FACE TO FACE		(H) - Open Height	APPROX. WT. (kg)	
NPS	DN		FL	BW		FL	BW
2	50	51	292	292	178	28	26
3	80	76	356	356	203	55	46
4	100	102	432	432	229	90	71
6	150	152	559	559	365	224	175
8	200	200	660	660	442	354	-
10	250	248	787	787	450	676	-
12	300	298	838	838	590	790	-
14	350	327	889	889	-	950	-
16	400	375	991	991	-	-	-
18	450	419	1092	1092	-	-	-
20	500	464	1194	1194	-	-	-
24	600	559	1397	1397	-	-	-

26" & above size design as per client requirement.

FL. : Flanged , BW : Butt weld
 As Kent Valve continuously endeavours to improve our products, the data given herein is subject to change.

SWING CHECK VALVE BOLTED COVER

900 # (API 6D / BS 1868)

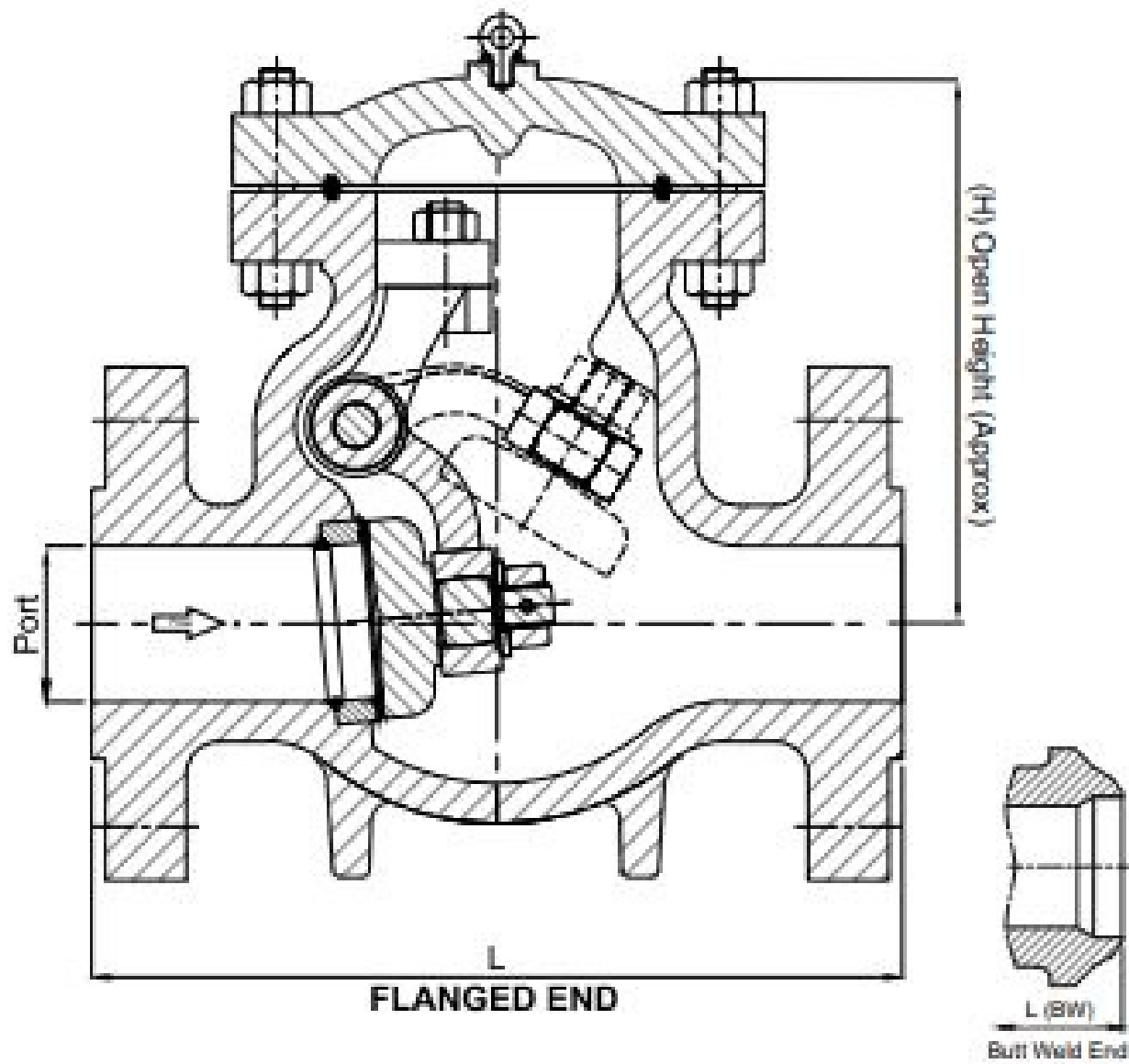

SL. NO.	DESCRIPTION	TYPICAL MATERIAL
1	Body	ASTM A 216 Gr. WCB
2	Seat ring(Seal Weld)	ASTM A 216 Gr. WCB + 13% Cr. Facing
3	Disc	ASTM A 216 Gr. WCB + 13% Cr. Facing
4	Hinge	ASTM A 216 Gr. WCB
5	Disc Washer	13% Cr. Steel
6	Disc Nut	SS304
7	Disc Nut pin	13% Cr. Steel
8	Hinge pin	13% Cr. Steel
9	Bracket	ASTM A 216 Gr. WCB
10	Gasket RTJ	Soft Iron / SS 316
11	Cover	ASTM A 216 Gr. WCB
12	Stud & Nut	ASTM A 193 Gr. B7 / ASTM A 194 Gr. 2H

- ★ Lifting Lug 2" & above
- ★ Drain Plug on request

DIMENSION TABLE, CLASS 900								
SIZE		PORT	(L) - FACE TO FACE			(H) - Open Height	APPROX. WT. (kg)	
NPS	DN		FL	BW	RTJ		FL/RTJ	BW
2	50	48	368	368	371	-	-	-
3	80	73	381	381	384	250	88	70
4	100	98	457	457	460	280	162	131
6	150	146	610	610	613	350	336	275
8	200	190	737	737	740	420	673	569
10	250	238	838	838	841	510	938	789
12	300	283	965	965	968	610	1480	1280

GO : Gear Operated , FL : Flanged , BW : Butt weld , RTJ : Ring Type Joint
 For RTJ flange dimension refers to standard ASME B16.5
 As Kent Valve continuously endeavour to improve our products, the data given herein is subject to change.



SWING CHECK VALVE BOLTED COVER

1500 # (API 6D / BS 1868)

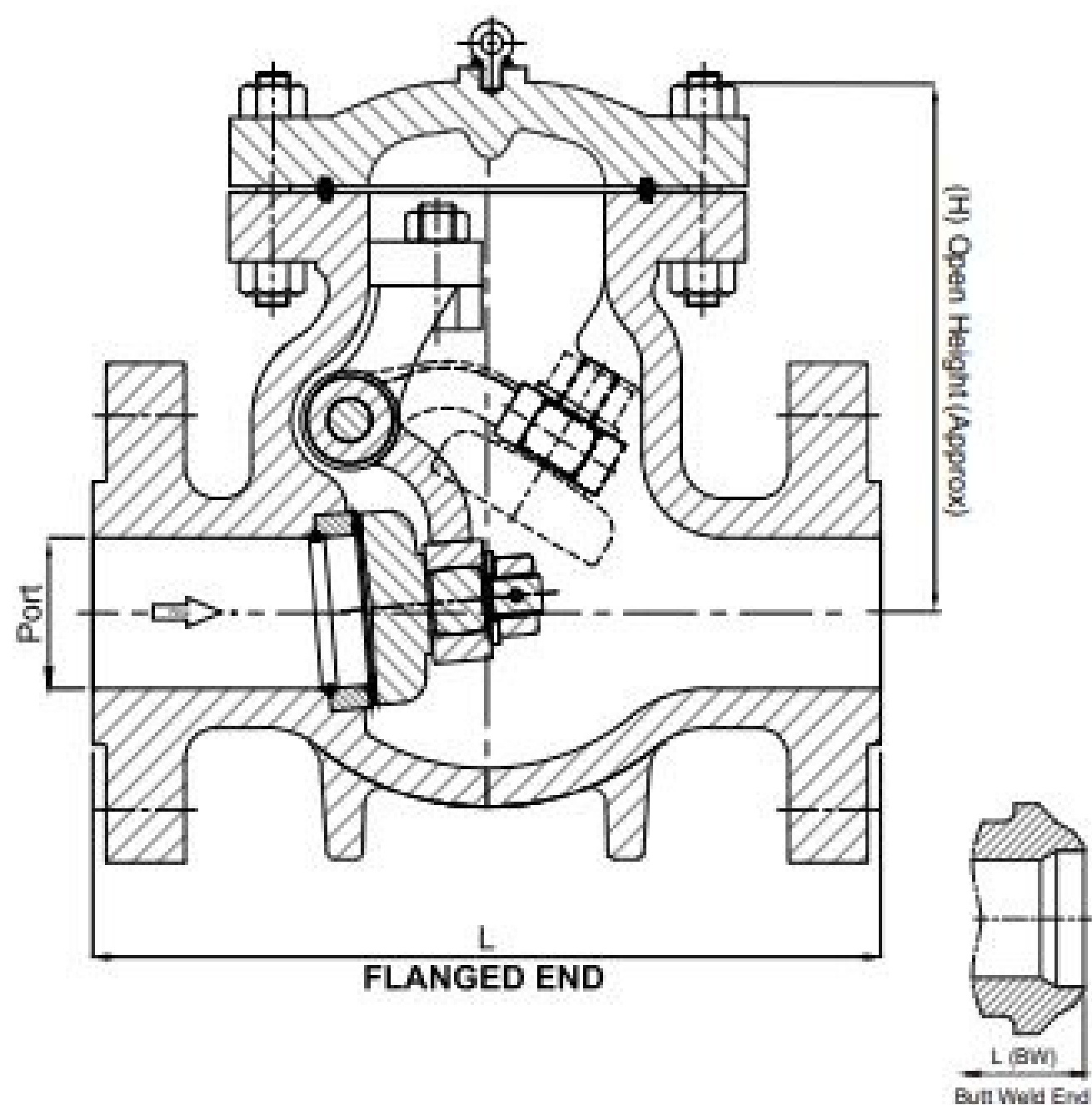

SL. NO.	DESCRIPTION	TYPICAL MATERIAL
1	Body	ASTM A 216 Gr. WCB
2	Seat ring (Seal Weld)	ASTM A 216 Gr. WCB + 13% Cr. Facing
3	Disc	ASTM A 216 Gr. WCB + 13% Cr. Facing
4	Hinge	ASTM A 216 Gr. WCB
5	Disc Washer	13% Cr. Steel
6	Disc Nut	SS304
7	Disc Nut pin	13% Cr. Steel
8	Hinge pin	13% Cr. Steel
9	Bracket	ASTM A 216 Gr. WCB
10	Gasket RTJ	Soft Iron/ SS 316
11	Cover	ASTM A 216 Gr. WCB
12	Stud & Nut	ASTM A 193 Gr. B7 / ASTM A 194 Gr. 2H

- ★ Lifting Lug 2" & above
- ★ Drain Plug on request

DIMENSION TABLE, CLASS 1500								
SIZE		PORT	(L) - FACE TO FACE			(H) - Open Height	APPROX. WT. (kg)	
NPS	DN		FL	BW	RTJ		FL/RTJ	BW
2	50	48	368	368	371	250	69	53
3	80	70	470	470	473	285	118	89
4	100	92	546	546	549	340	177	134
6	150	137	705	705	711	400	566	467
8	200	178	832	832	842	465	892	728
10	250	222	991	991	1001	570	1730	1447
12	300	264	1130	1130	1146	680	2580	2157

Valves above 1500 class, information can be furnished on request.

GO : Gear Operated , FL : Flanged , BW : Butt weld , RTJ : Ring Type Joint
 For RTJ flange dimension refers to standard ASME B16.5
 As Kent Valve continuously endeavour to improve our products, the data given herein is subject to change.



ORDERING INFORMATION

A	B	C	D	E	F	G
GTB	04	006	RT	16	08	HO

A	
VALVE TYPE MODEL CODE	
GATE VALVE BOLTED BONNET	GTB
GLOBE VALVE BOLTED BONNET	GBB
SWING CHECK VALVE BOLTED BONNET	SCB

For SCB size 2" & above.

B	
SIZE	
1/2"	OH
1"	O1
3/4"	3F
1 1/4"	1F
1 1/2"	1H
3"	03
4"	04
5"	05
6"	06
8"	08
10"	10
12"	12
14"	14
16"	16
18"	18
20"	20
24"	24
26"	26
28"	28
30"	30
32"	32
34"	34
36"	36
38"	38
40"	40
42"	42

C	
PRESSURE CLASS	
CLASS	* FORGED
150	001
300	003
600	006
900	009
1500	015
2500	025

D	
END CONNECTION CODE	
FLANGE RF	FR
FLANGE FF	FF
RING TYPE JOINT	RT
BWE	BW
BWE SHORT	BS

END CONNECTION 26" & above	
AWWA	AW
ASME B 16.47 - A	4A
ASME B 16.47 - B	4B

E	
BODY MATERIAL ASTM	
A 216 Gr. WCB	16
A 216 Gr. WCC	17
A 352 Gr. LCC	18
A 352 Gr. LCB	19
A 217 GR. WC6	20
A 217 GR. WC9	21
A 217 GR. C5	22
A 351 GR. CF3	23
A 351 GR. CF8	24
A 351 GR. CF3M	25
A 351 GR. CF8M	26
A 351 GR. CF8C	27
A 351 GR. CN7M	28
A 890 GR. 5A	29

F			
TRIM MATERIAL			
TRIM NO.	SEAT	WEDGE /PLUG/ DISC	STEM /BUSH
01	13 % Cr	13 % Cr	13 % Cr
02	SS304	SS304	SS316
05	HF*	HF*	13 % Cr
08	HF*	13 % Cr	13 % Cr
09	MONEL	MONEL	MONEL
10	SS316	SS316	SS316
12	HF*	SS316	SS316
16	HF*	HF*	SS316

* HF : Hard-faced with Stellite #6 (Co-Cr-W alloy) or equivalent. Trim 8 valves can also be offered for NACE service on request. Trim 12 valves comply with NACE MR 01 75 for hardness and heat treatment requirements of wetted components.

G	
OPERATOR	
HANDWHEEL OPERATED	HO
GEAR OPERATED	GO
PNEUMATIC ACTUATOR	PA
HYDRAULIC ACTUATOR	HA
ELECTRIC ACTUATOR	EA
BARE STEM	BS

SPECIAL REQUIREMENT	
LOCKING ARRANGEMENT	LA
EXTENDED BONNET	EB
CRYOGENIC VALVE	CR
EXTENDED STEM	ES
IBR CERTIFICATE	IB
BYPASS SERVICE	BS
FULL STEM JACKET	FJ
PARTIAL STEM JACKET	PJ

Note :- Other Combination if required, please ask.

OFFICE AND FACTORY



KENT VALVE
CRITICAL PRESSURE & FLOW CONTROL



UK

Kent Valve Ltd.

**Unit b4; Greeba Road; Southmoor Park, Wythenshawe;
Greater Manchester, England Post Code – M23 9XS
United Kingdom**

✉ Email Id : Sales.uk@Kentvalve.com



UAE

Kent Valve FZE

**Plot No.1H-08B, PO Box 51722
Hamriyah Free Zone, Phase 1, Sharjah,
United Arab Emirates**

✉ Email Id : Sales.uae@Kentvalve.com



ITALY

Kent Valve SRL

**Autocontrol Europe SRL Via Vittorio Veneto,
23 Cap 20010 Bernate Ticino Milano,
Italy**

✉ Email Id : Sales.europe@Kentvalve.com



INDIA

Kent Valve Pvt. Ltd.

**Plot No-B-85/4, Ambernath Additional MIDC,
Anand Nagar, Nr. ASB Company, Ambernath, Thane,
Maharashtra, India - 421506.**

✉ Email Id : Sales.india@Kentvalve.com